

WEIGHT (LBS)
149

ECO No	DESCRIPTION	REV BY	DATE
M11976	REMOVED DOGBONES OFF OF LUG VIEW.	WF	09/18/19

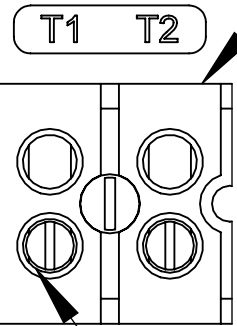

SEE NOTE 2

SEE NOTE 1

CUSTOMER CONNECTION
DETAIL VIEW (THERMAL)

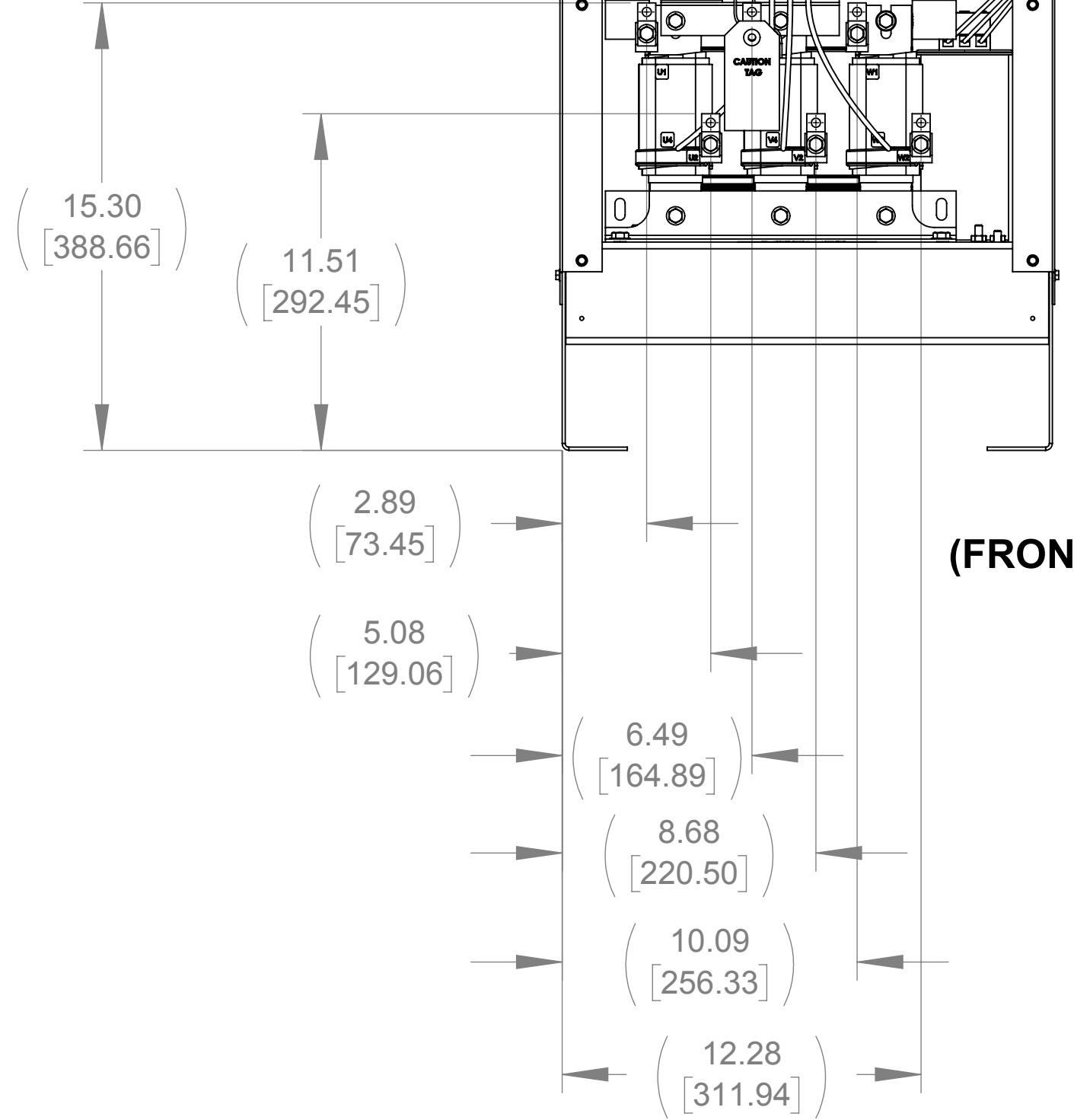

FRONT VIEW
(FRONT PANEL REMOVED)

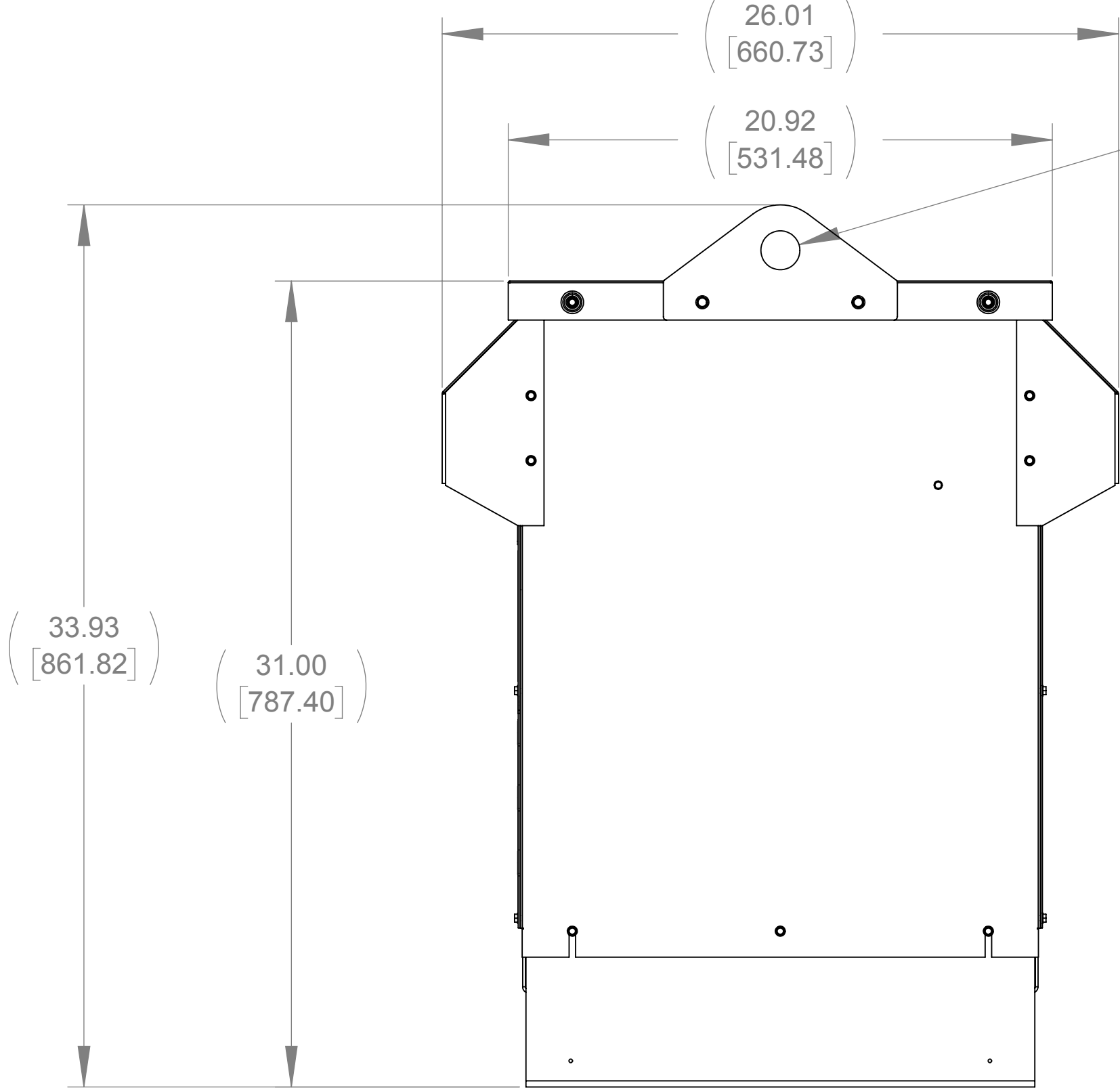

RIGHT SIDE VIEW

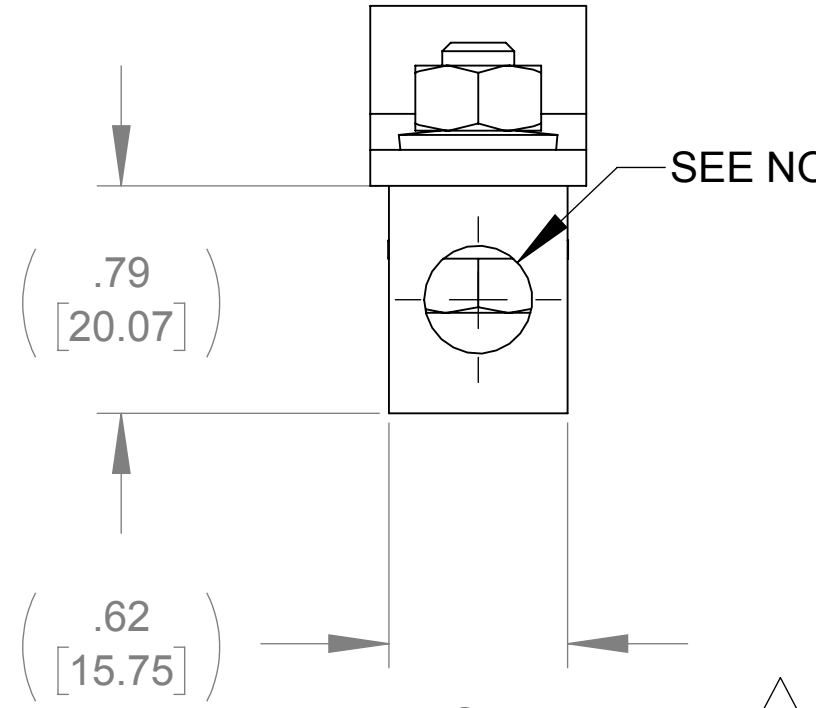

LUG VIEW
(TYP 6 PLACES
U1, U2, W1
U2, V2, W2 TERMINALS)

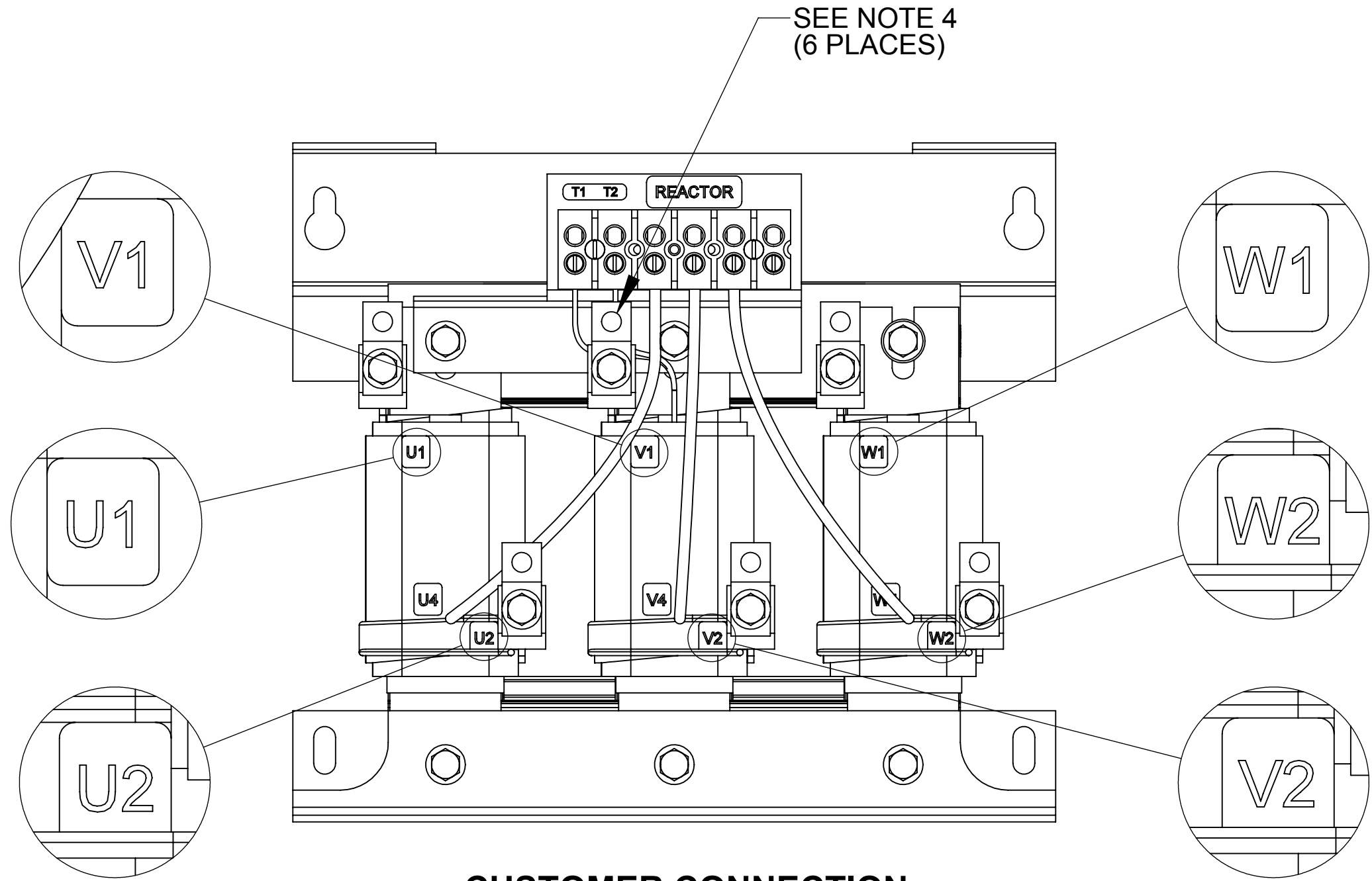
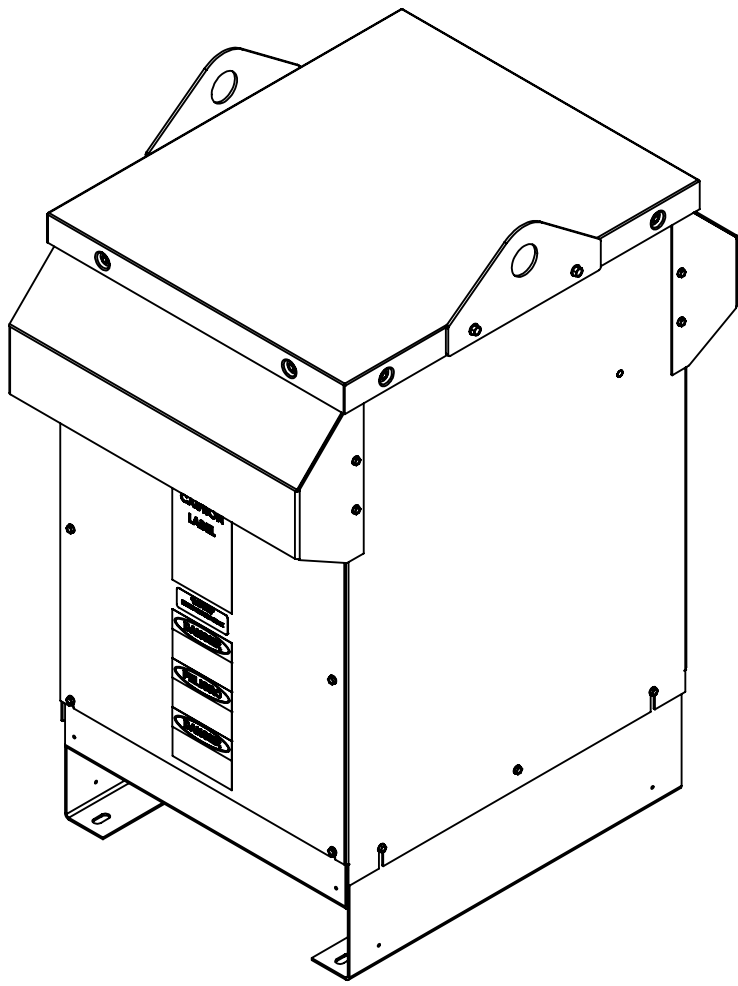

CUSTOMER CONNECTION
DETAIL VIEW

NOTES:

1. TIGHTEN TERMINAL BLOCK SCREWS TO 16 IN/LBS. TORQUE, MAX.
2. TERMINAL WIRE SIZE: 4-14 AWG.
3. TERMINAL WIRE SIZE: 14 AWG - 1/0 AWG..
4. TIGHTEN TERMINAL BLOCK SCREWS TO 45 IN/LBS. TORQUE, MAX.

THE COMPONENT, PART OR ASSEMBLY DESCRIBED IN THIS DOCUMENT MUST COMPLY WITH THE EU(EUROPEAN UNION) DIRECTIVE RoHS2			MATERIAL		CONFIDENTIAL AND PROPRIETARY INFORMATION THIS DOCUMENT CONTAINS CONFIDENTIAL AND PROPRIETARY INFORMATION OF MTE CORPORATION AND MAY NOT BE USED, COPIED OR DISCLOSED TO OTHERS EXCEPT WITH THE AUTHORIZED WRITTEN PERMISSION OF MTE CORPORATION		
CONTAINS <0.1% OF ANY SVHC BY WEIGHT PER REACH REGULATION					DESCRIPTION		
UNLESS OTHERWISE SPECIFIED DIMENSIONS ARE IN INCHES [MM] TOLERANCES ARE: ANGLES: ± 1 ° 1 PLACE .X: ± .1 [2.5] 2 PLACE .XX: ± .03 [0.76] 3 PLACE .XXX: ± .010 [0.254]			DRAWN MN	DATE 09/06/13	SWG 65A 380-480V 2-8kHz FILTER NEMA 3R		
			CHECKED WF	DATE 09/18/19	SIZE D	DWG No. CD SWGW0065D	REV 03
			APPROVED AK	DATE 09/19/19	SCALE 1:4	SHEET 1 OF 1	



N83 W13330 Leon Road
Menomonee Falls, WI 53051 USA
800.455.4693
262.253.8200