

APPROX. WEIGHT
(LBS)
75

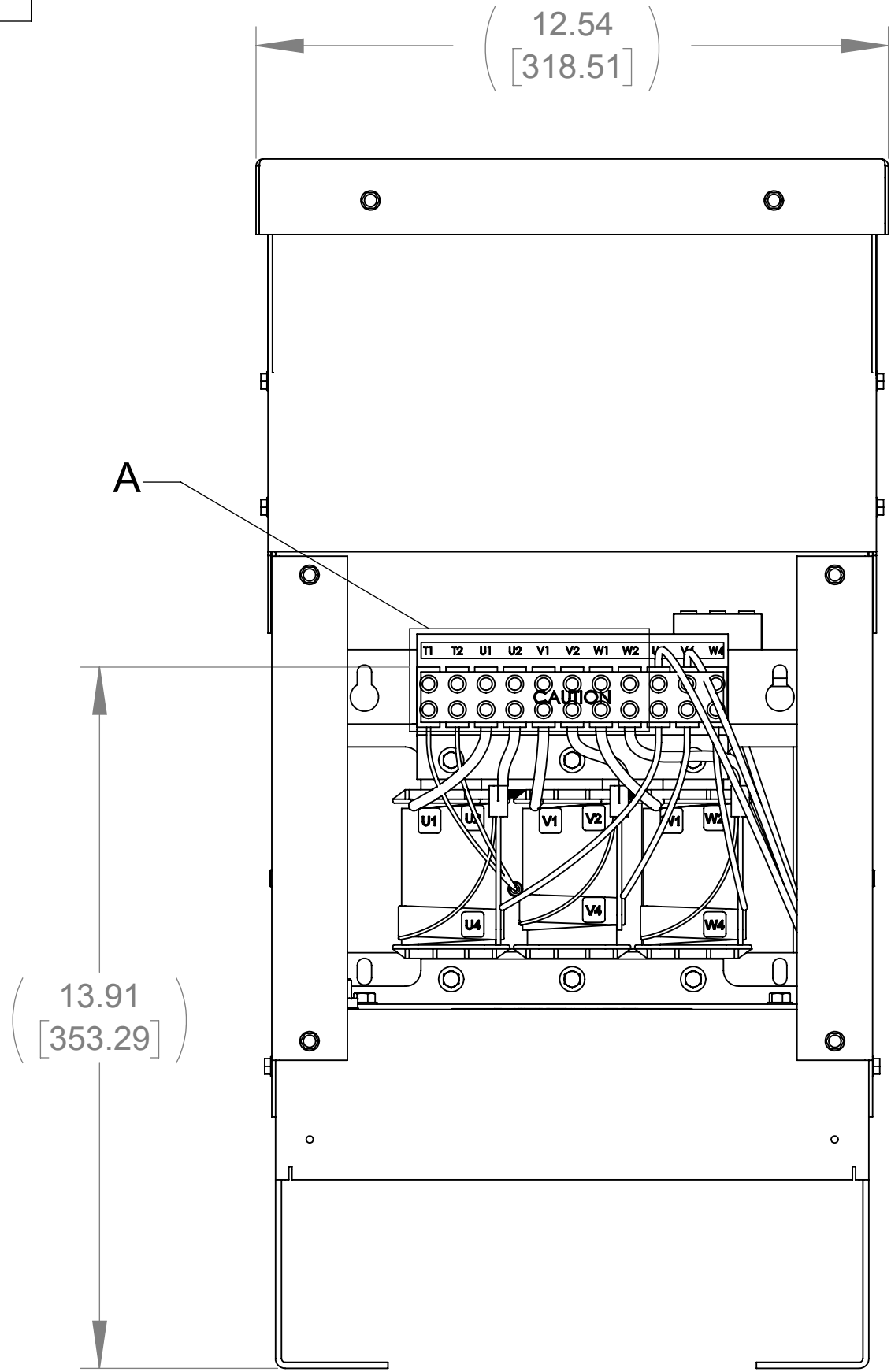

FRONT VIEW
(PANELS REMOVED)

(23.99)
[609.31]

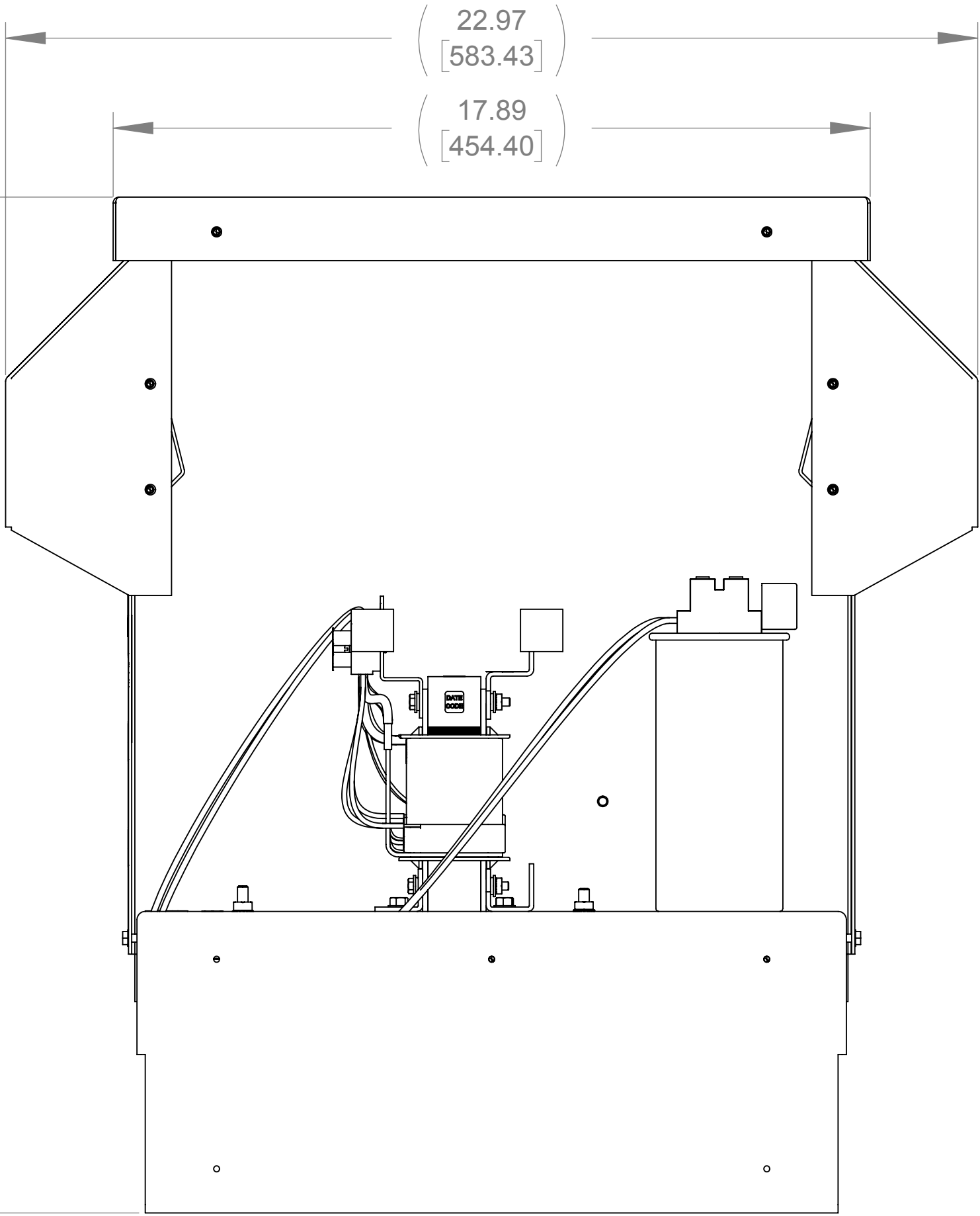

SIDE VIEW
(PANELS REMOVED)

(.41 [10.41] X .88 [22.35])
SLOT, 4 PLACES

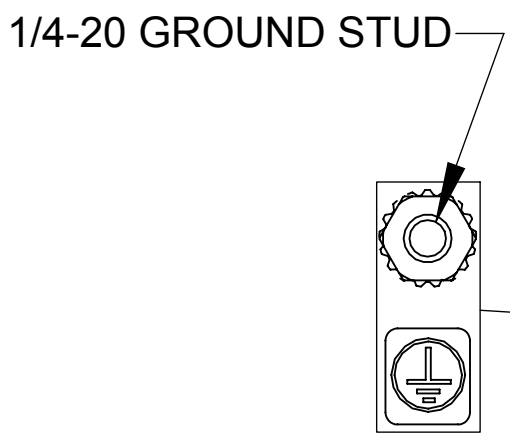

TOP VIEW
(PANELS REMOVED)

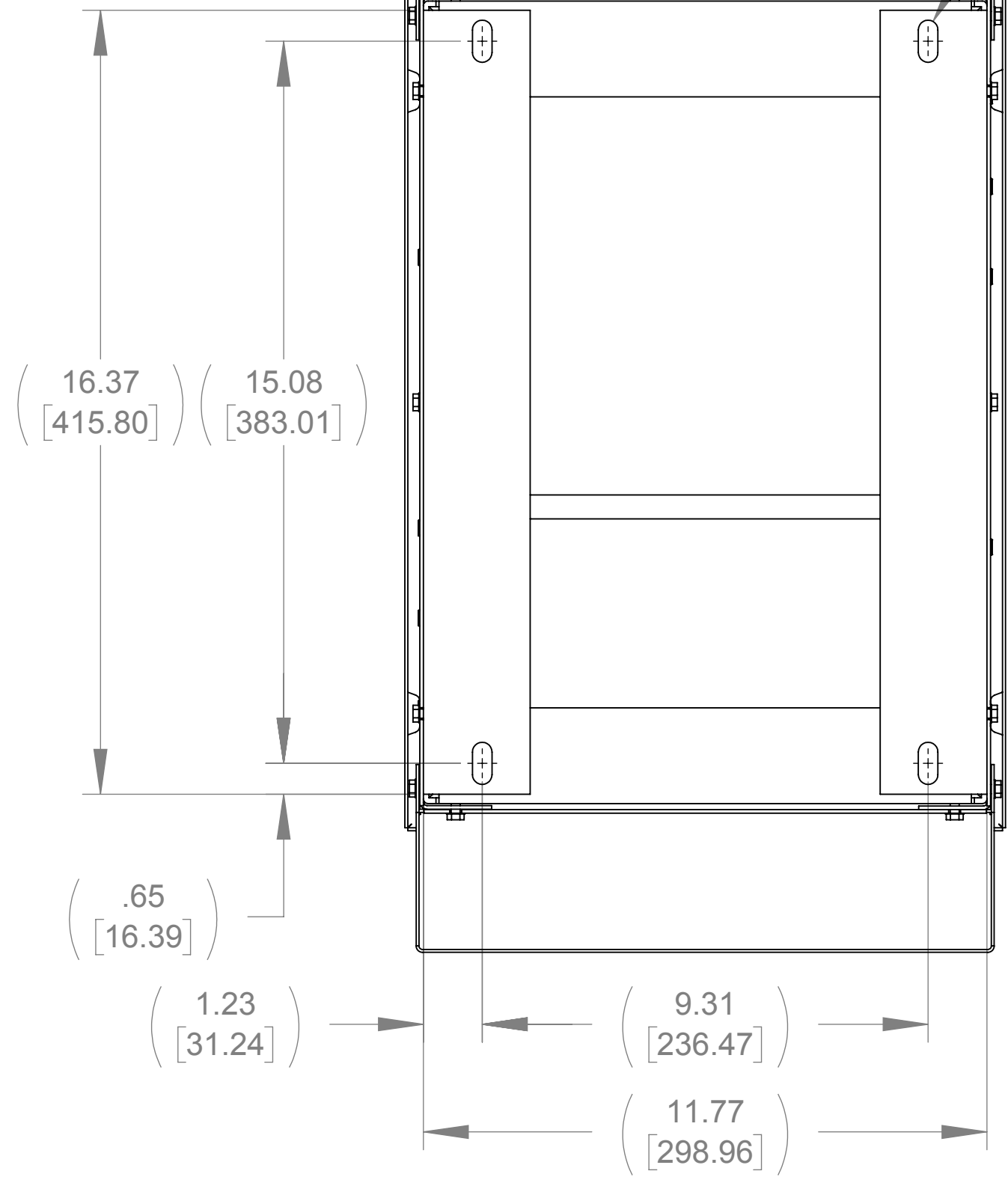

BOTTOM VIEW

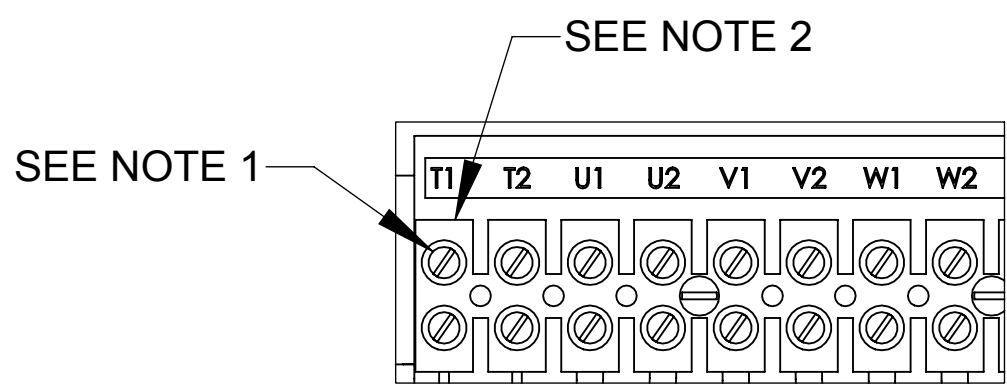

DETAIL A
CUSTOMER CONNECTION
DETAIL VIEW

NOTES:

1. TIGHTEN TERMINAL BLOCK SCREWS TO 16 IN/LBS. TORQUE.
2. TERMINAL WIRE SIZE: 4-14 AWG.

THE COMPONENT, PART OR ASSEMBLY DESCRIBED IN THIS DOCUMENT MUST COMPLY WITH THE EU(EUROPEAN UNION) DIRECTIVE RoHS2				MATERIAL		CONFIDENTIAL AND PROPRIETARY INFORMATION THIS DOCUMENT CONTAINS CONFIDENTIAL AND PROPRIETARY INFORMATION OF MTE CORPORATION AND MAY NOT BE USED, COPIED OR DISCLOSED TO OTHERS EXCEPT WITH THE AUTHORIZED WRITTEN PERMISSION OF MTE CORPORATION		
CONTAINS <0.1% OF ANY SVHC BY WEIGHT PER REACH REGULATION						DESCRIPTION		
UNLESS OTHERWISE SPECIFIED DIMENSIONS ARE IN INCHES [MM] TOLERANCES ARE: ANGLES: ± 1 ° 1 PLACE .X: ± .1 [2.5] 2 PLACE .XX: ± .03 [0.76] 3 PLACE .XXX: ± .010 [0.254]				DRAWN MN	DATE 07/20/18	SWG 12A 380-480V 2-8kHz FILTER, NEMA 3R ENCL.		
				CHECKED MN	DATE 07/23/18			
				APPROVED TL	DATE 10/10/18	SIZE D	DWG No. CD SWGW0012E	REV 00
				SCALE 1:3		SHEET 1 OF 1		

MTE
POWER QUALITY. SOLVED.

N83 W13330 Leon Road
Menomonee Falls, WI 53051 USA
800.455.4683
262.253.8200