

ECO No	DESCRIPTION	REV BY	DATE
M9935	REPLACED CAPPANEL-578 WITH CAPPANEL-578C	SL	01/19/17

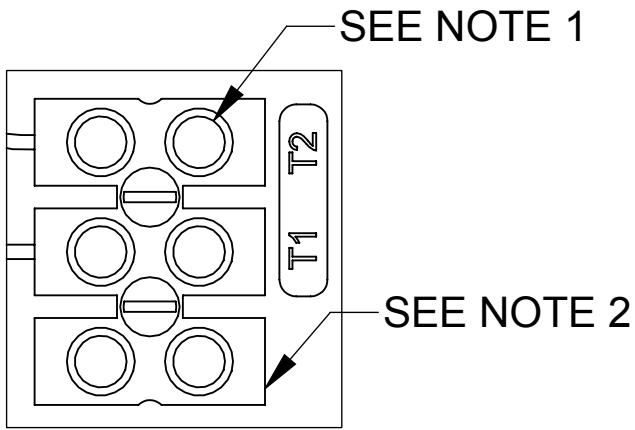

DETAIL C
CUSTOMER CONNECTION
DETAIL VIEW (THERMAL)

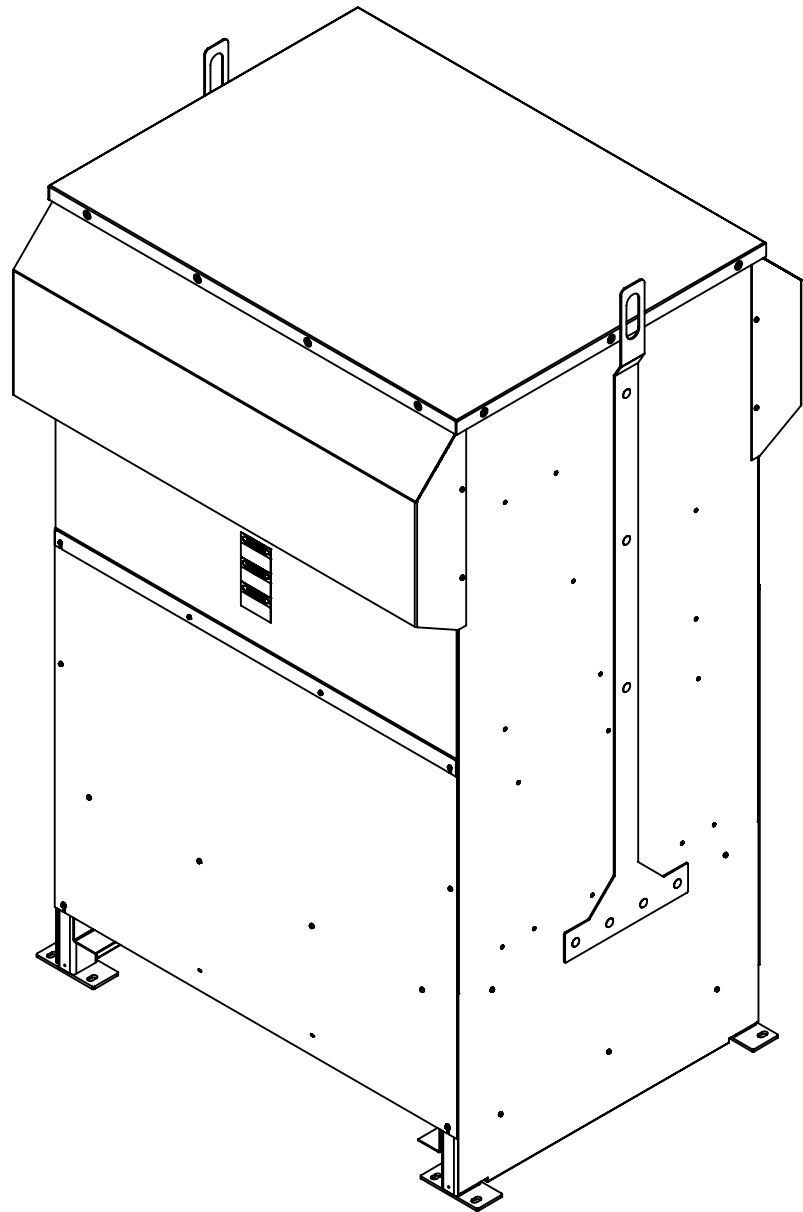
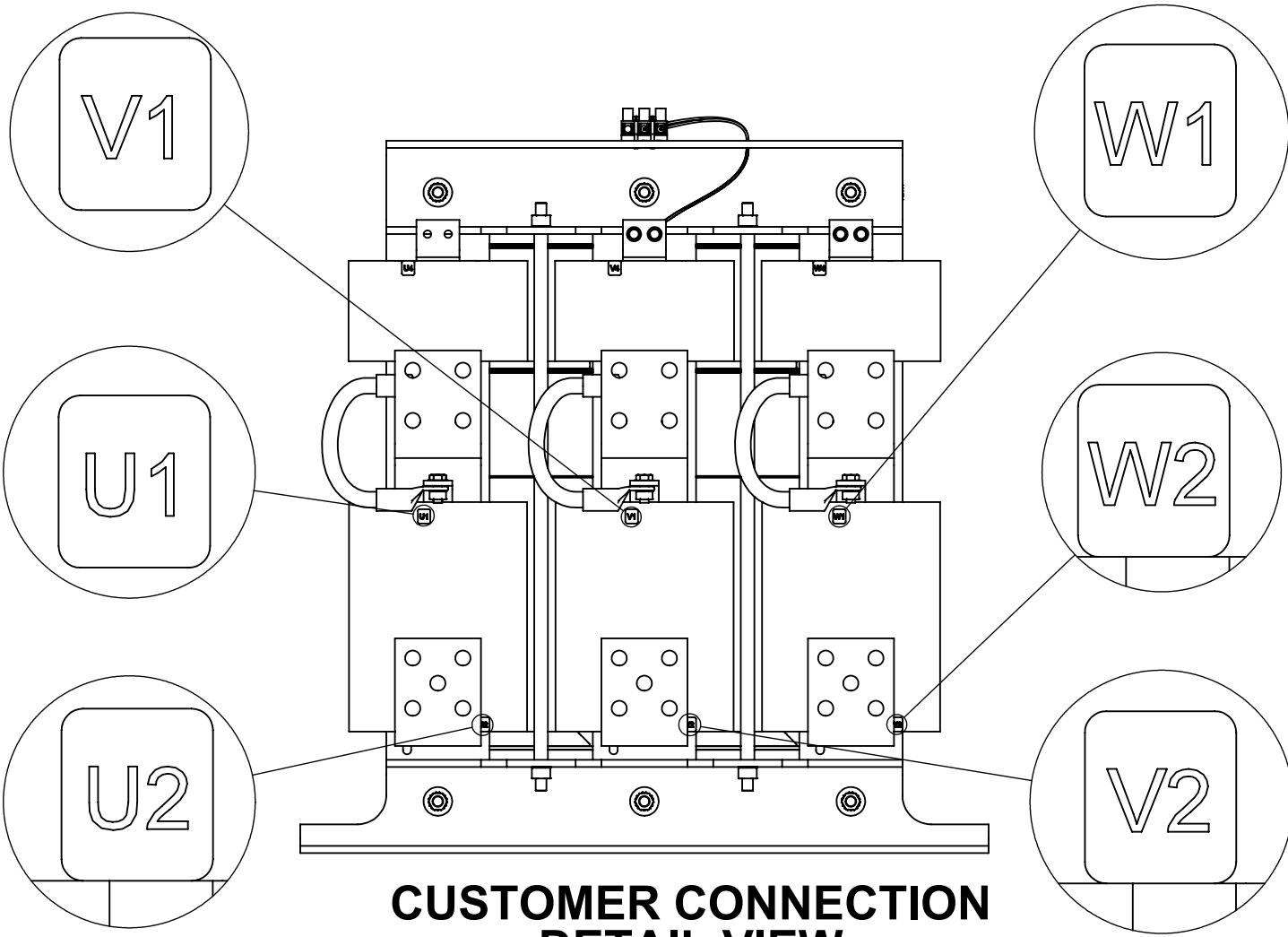

CUSTOMER CONNECTION
DETAIL VIEW

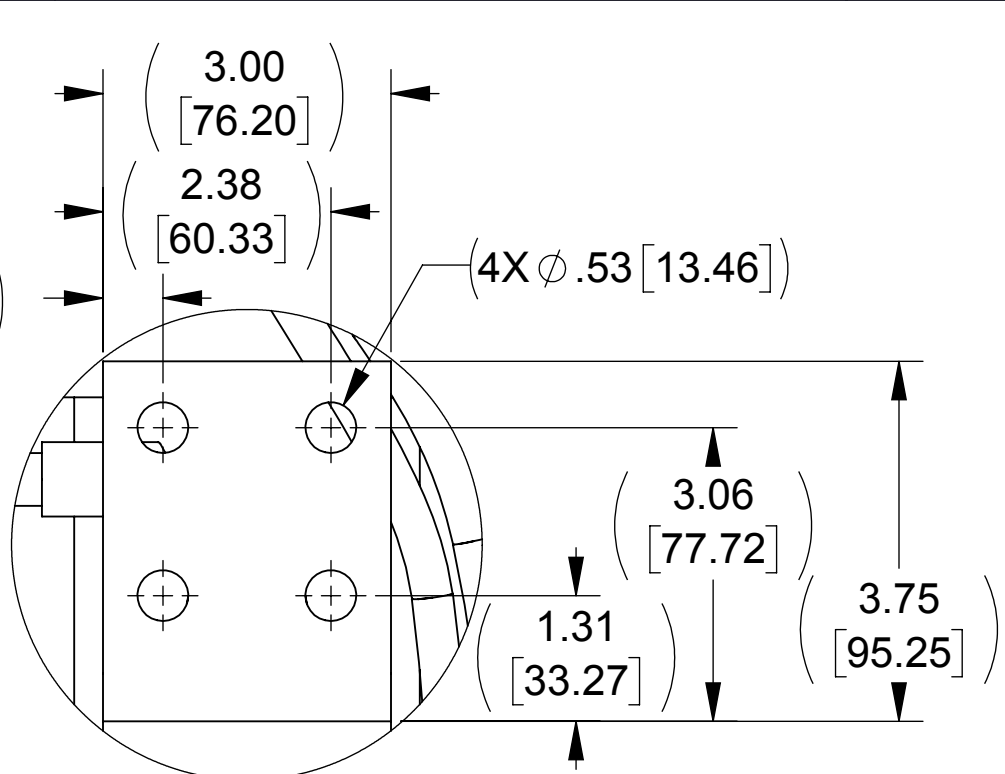

DETAIL A
(3 PLACES)

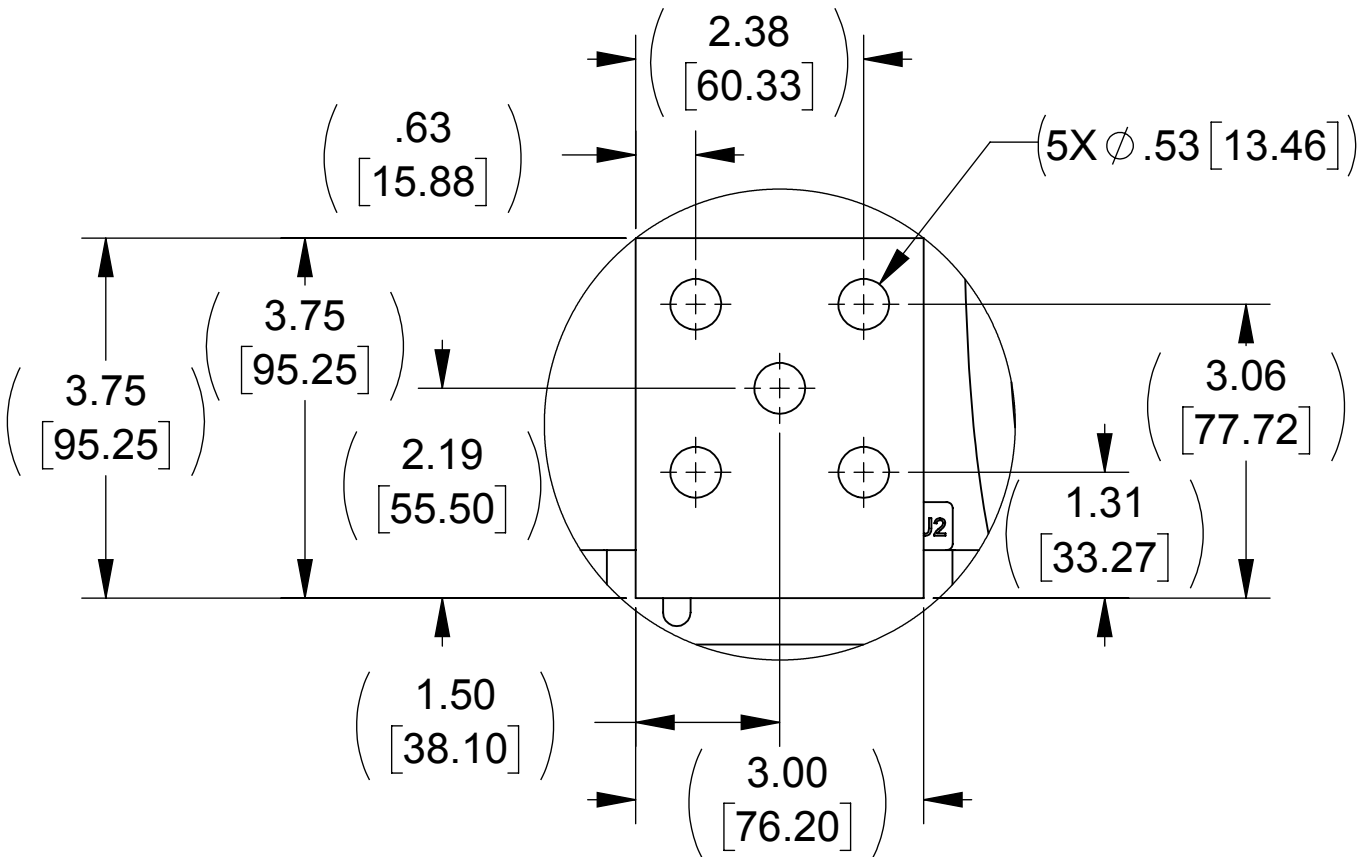

DETAIL B
(3 PLACES)

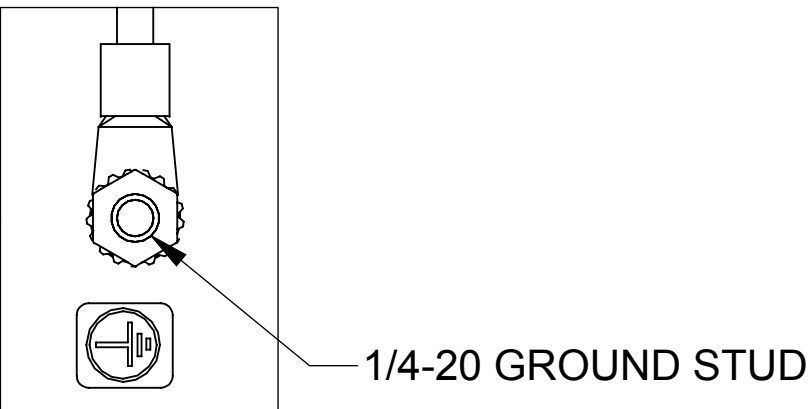

GROUND STUD DETAIL

NOTES:

1. TERMINAL SCREW TIGHTENING TORQUE: 16 IN/LBS, MAX.
2. WIRE RANGE: 4-14 AWG.

THE COMPONENT, PART OR ASSEMBLY DESCRIBED IN THIS DOCUMENT MUST COMPLY WITH THE EU(EUROPEAN UNION) DIRECTIVE RoHS2		MATERIAL		CONFIDENTIAL AND PROPRIETARY INFORMATION THIS DOCUMENT CONTAINS CONFIDENTIAL AND PROPRIETARY INFORMATION OF MTE CORPORATION AND MAY NOT BE USED, COPIED OR DISCLOSED TO OTHERS EXCEPT WITH THE AUTHORIZED WRITTEN PERMISSION OF MTE CORPORATION	
CONTAINS <0.1% OF ANY SVHC BY WEIGHT PER REACH REGULATION				DESCRIPTION	
UNLESS OTHERWISE SPECIFIED DIMENSIONS ARE IN INCHES [MM] TOLERANCES ARE: ANGLES: ± 1 ° 1 PLACE .X: ± .1 [2.5] 2 PLACE .XX: ± .01 [0.25] 3 PLACE .XXX: ± .005 [0.127]		DRAWN JS	DATE 05/22/13	MATRIX AP 786A 600V 60HZ FILTER, NEMA 3R ENCLOSURE	
		CHECKED JM	DATE 02/16/17	SIZE D	DWG No. CD MAPW0786E
		APPROVED JM	DATE 02/16/17	REV 03	
		SCALE 1:8		SHEET 1 OF 1	

