

APPROX. WEIGHT (LBS)
1129

ECO No	DESCRIPTION	REV BY	DATE
M9783	CHANGED CAPPANEL-543 TO 543C	MN	02/29/16

D

C

B

A

D

C

B

A

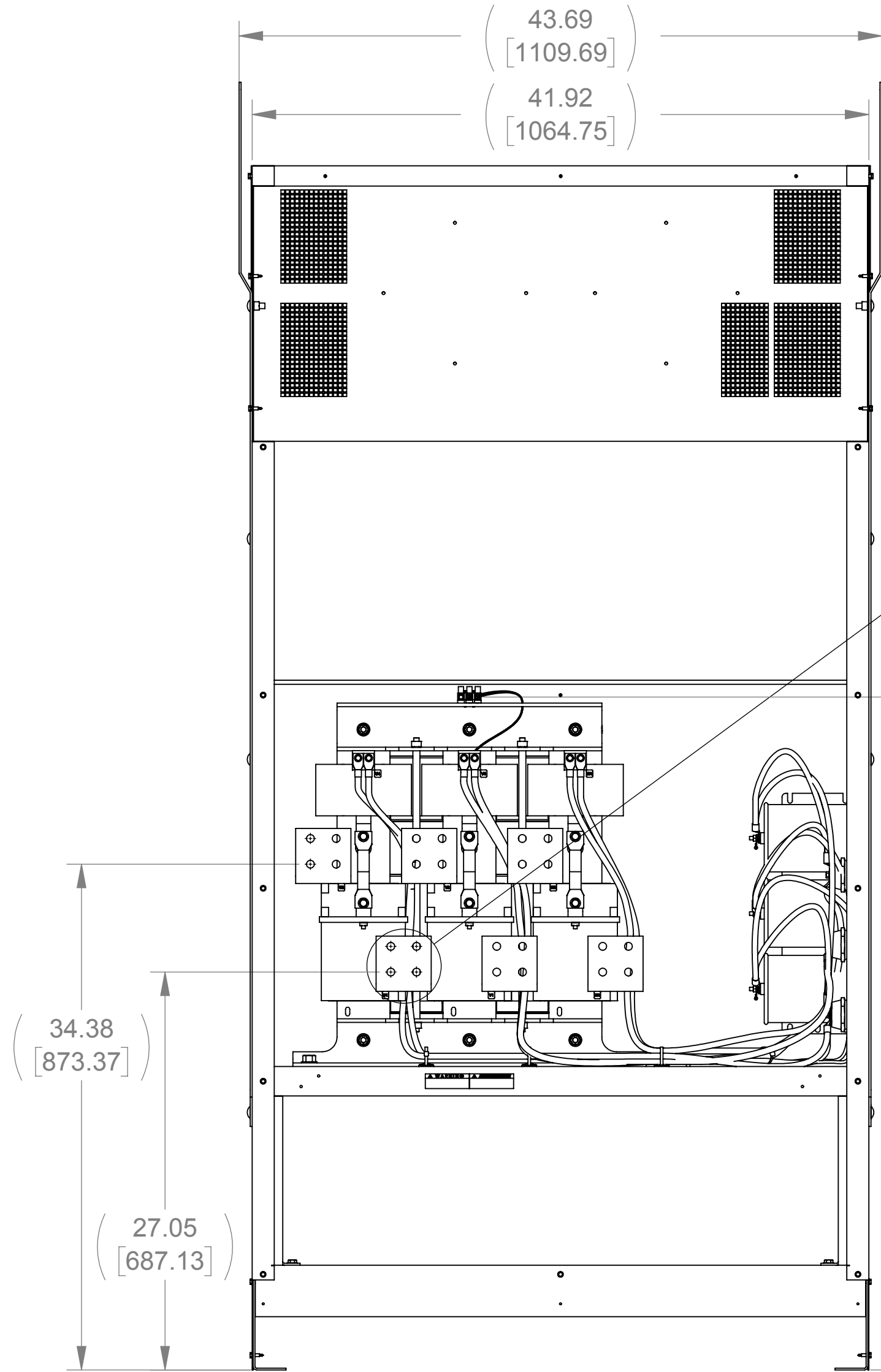

FRONT VIEW
(PANELS REMOVED)

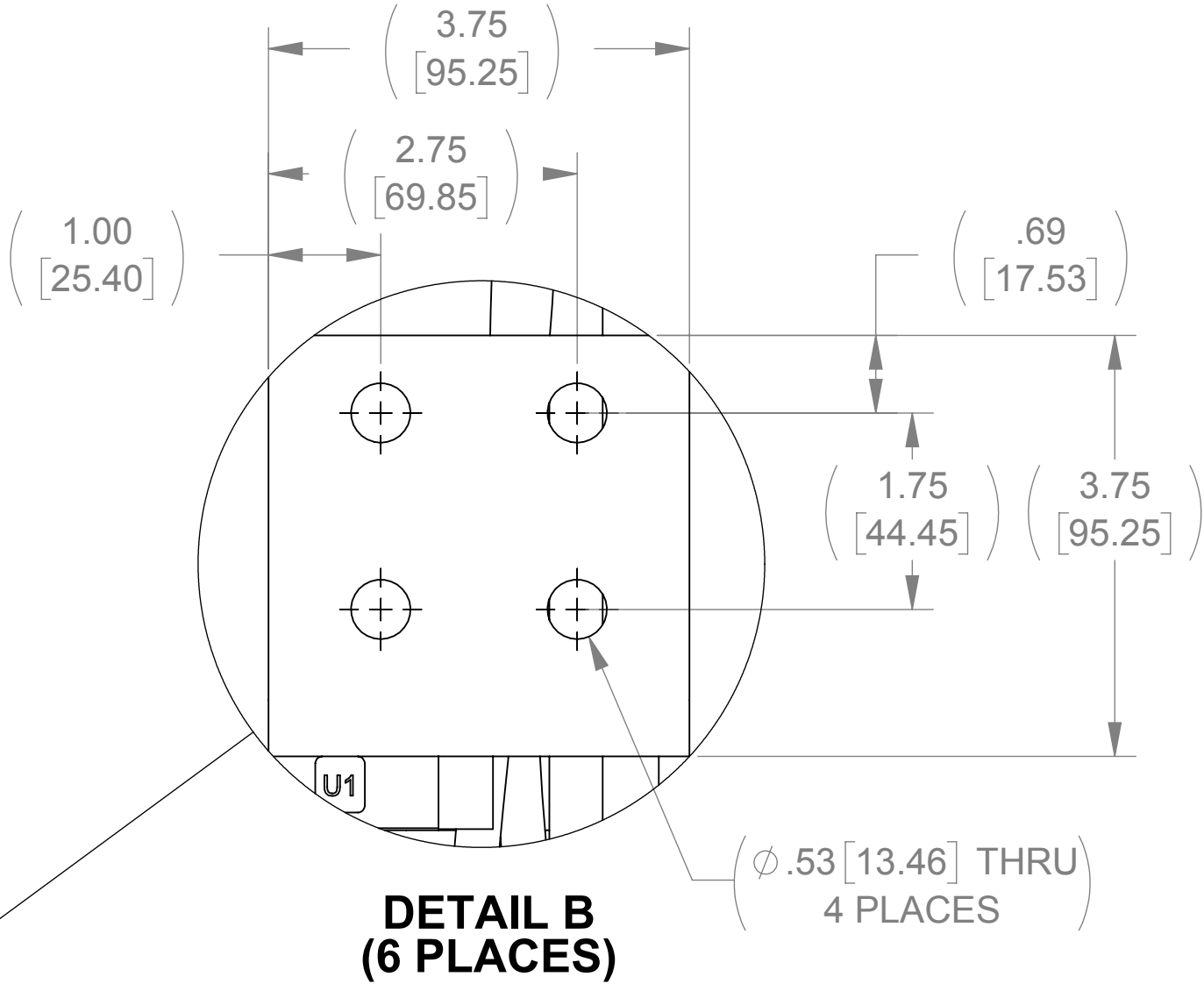

DETAIL B
(6 PLACES)

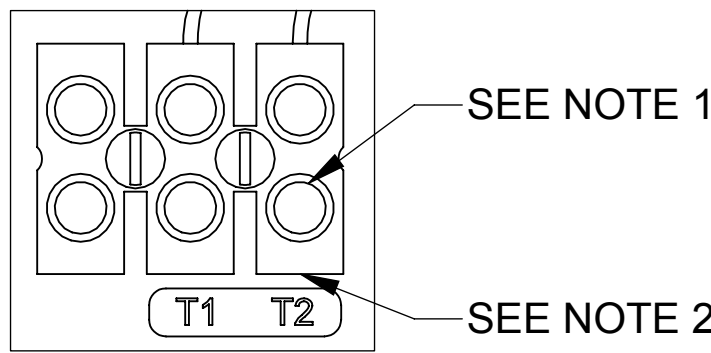

DETAIL A
CUSTOMER CONNECTION
DETAIL VIEW (THERMAL)

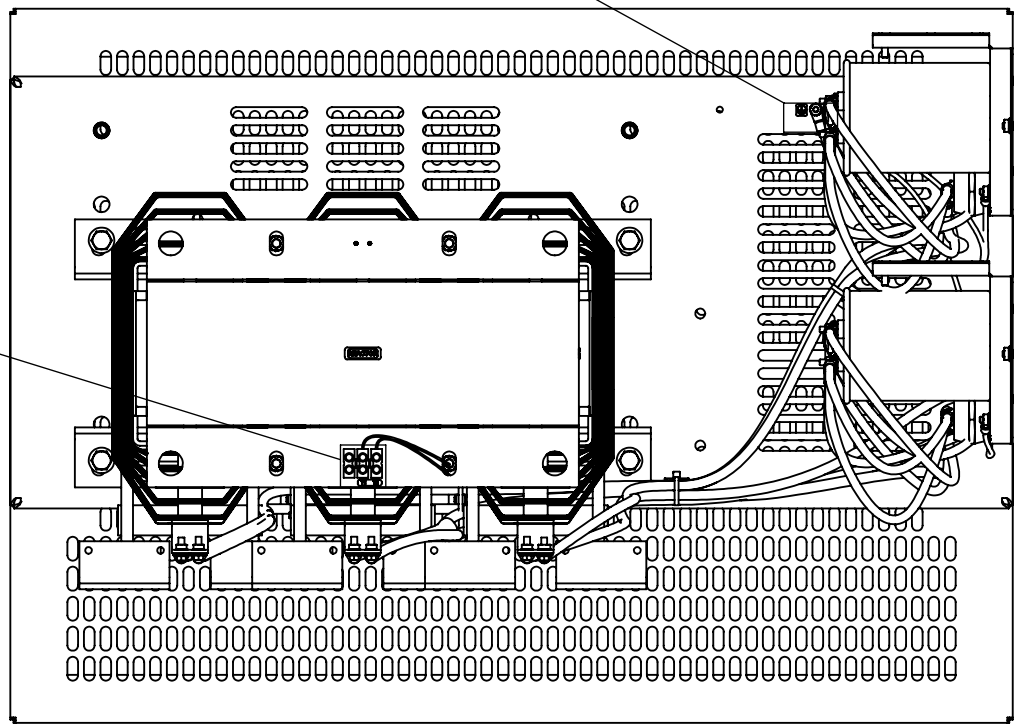
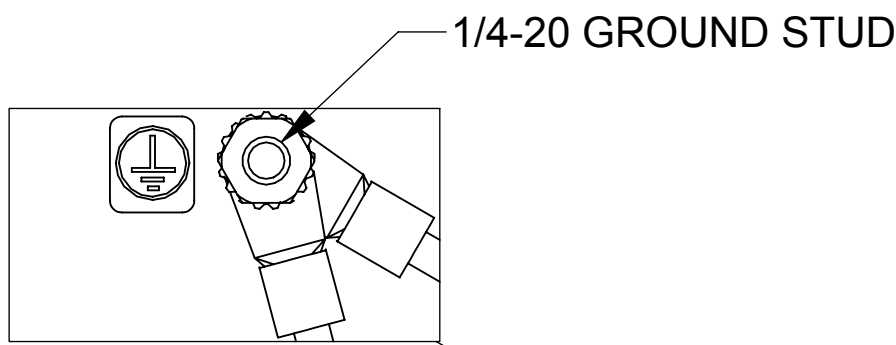

TOP VIEW
(PANELS REMOVED)

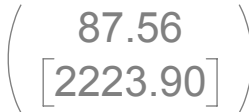

RIGHT SIDE VIEW

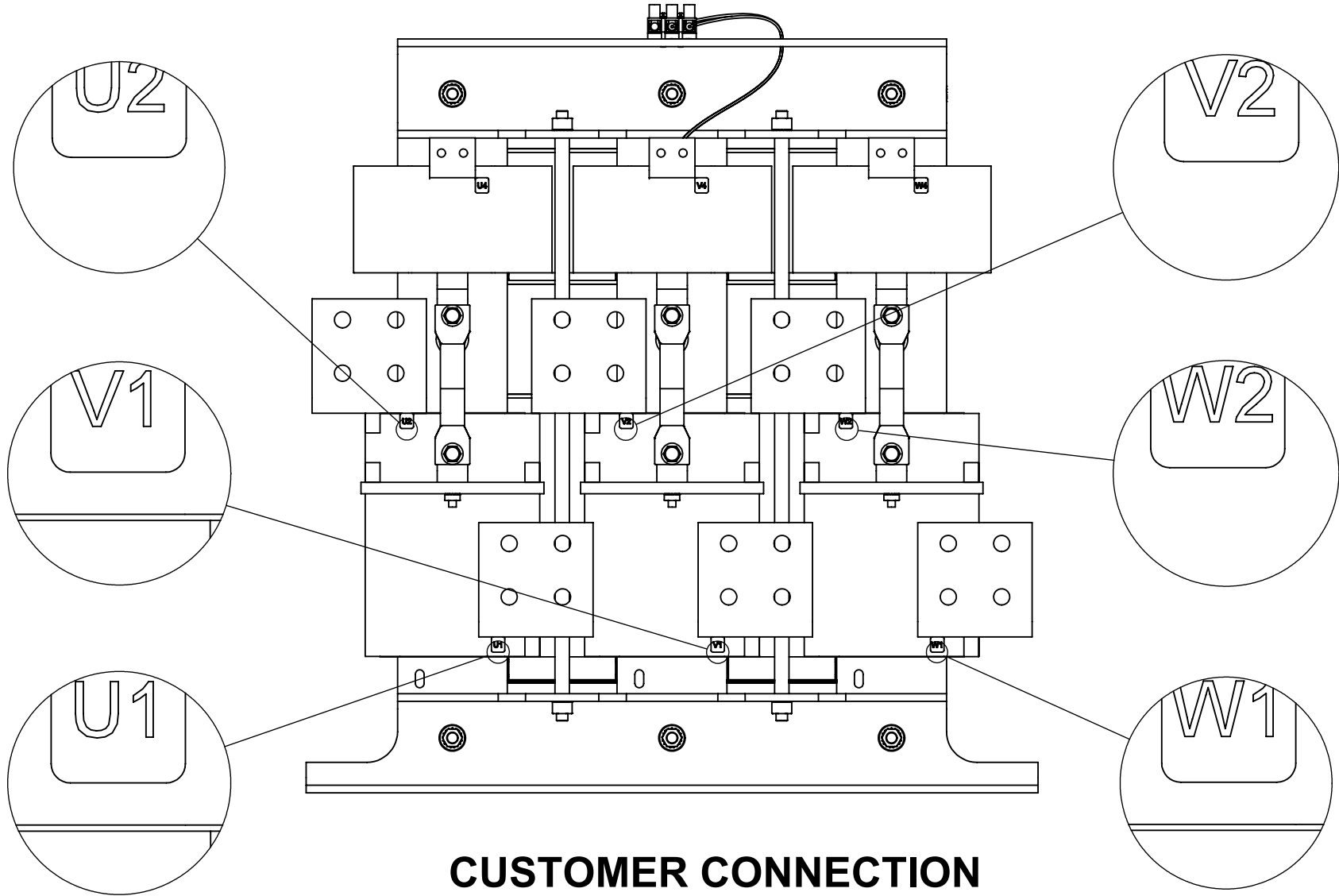
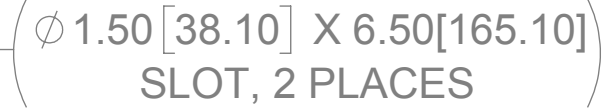

CUSTOMER CONNECTION
DETAIL VIEW

NOTES:

1. TERMINAL SCREW TIGHTENING TORQUE: 16 IN/LBS.
2. WIRE RANGE: 4-14 AWG.

THE COMPONENT, PART OR ASSEMBLY DESCRIBED IN THIS DOCUMENT MUST COMPLY WITH THE EU (EUROPEAN UNION) DIRECTIVE RoHS		MATERIAL		CONFIDENTIAL AND PROPRIETARY INFORMATION THIS DOCUMENT CONTAINS CONFIDENTIAL AND PROPRIETARY INFORMATION OF MTE CORPORATION AND MAY NOT BE USED, COPIED OR DISCLOSED TO OTHERS EXCEPT WITH THE AUTHORIZED WRITTEN PERMISSION OF MTE CORPORATION		
CONTAINS <0.1% OF ANY SVHC BY WEIGHT PER REACH REGULATION				DESCRIPTION		
UNLESS OTHERWISE SPECIFIED DIMENSIONS ARE IN INCHES [MM] TOLERANCES ARE: ANGLES: ± 1 ° 1 PLACE .XX: ± .1 [2.5] 2 PLACE .XX: ± .03 [0.76] 3 PLACE .XXX: ± .010 [0.254]		DRAWN MM 11/04/13		MATRIX AP 636A 480V 60HZ FILTER, NEMA 3R ENCL		
		CHECKED JM 03/21/16		DATE 03/21/16		
		APPROVED JM 03/21/16		DATE 03/21/16		
				SIZE D CD MAPW0636D		
				REV 10		
				SCALE 1:8 SHEET 1 OF 1		



N83 W13330 Leon Road
Menomonee Falls, WI 53051 USA
800.455.4683
262.253.8200