

APPROX. WEIGHT
(LBS)
114

ECO No	DESCRIPTION	REV BY	DATE
M11414	ADD MISSING WEIGHT	SM	12/07/18

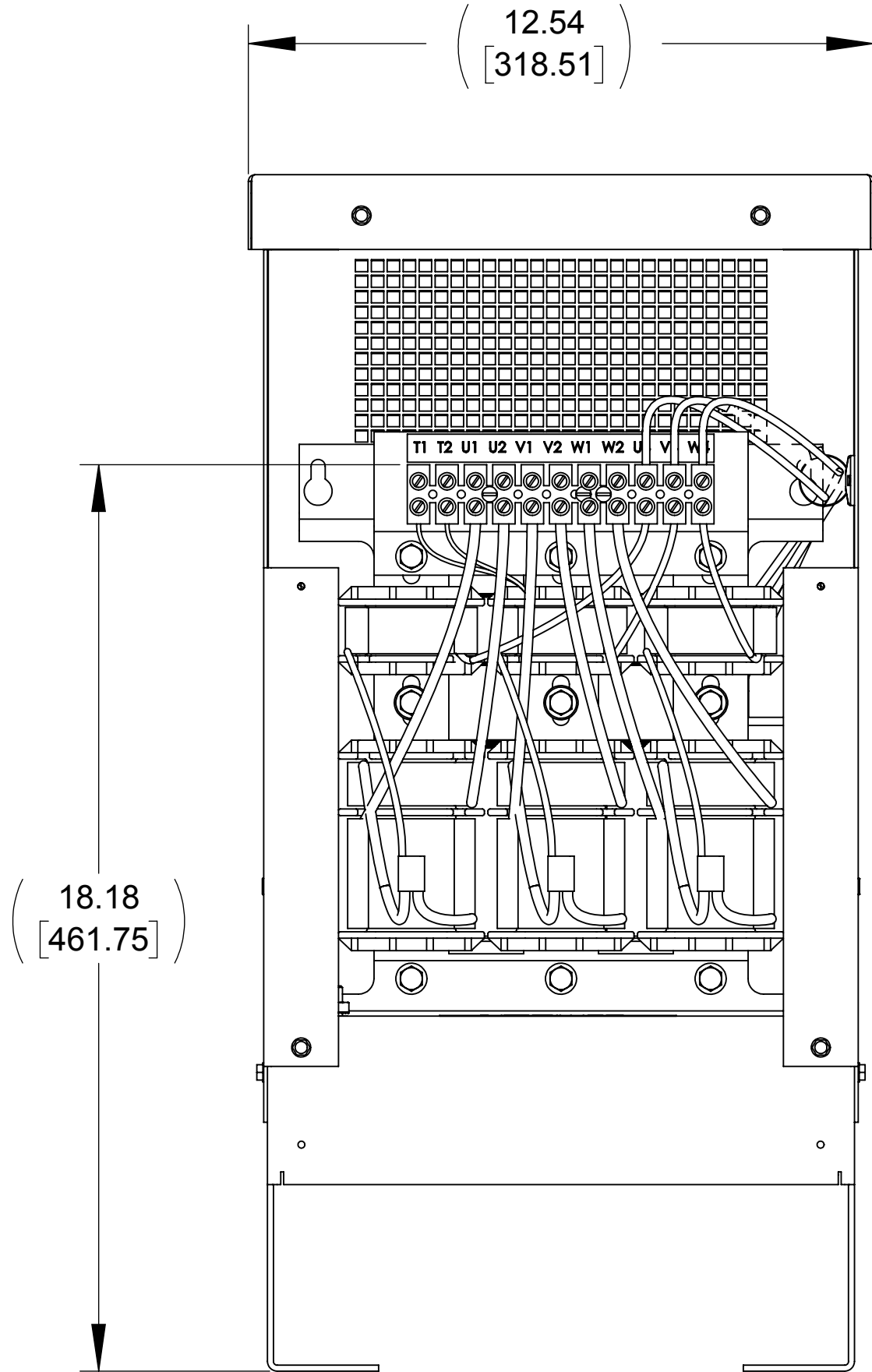

FRONT VIEW
(PANELS REMOVED)

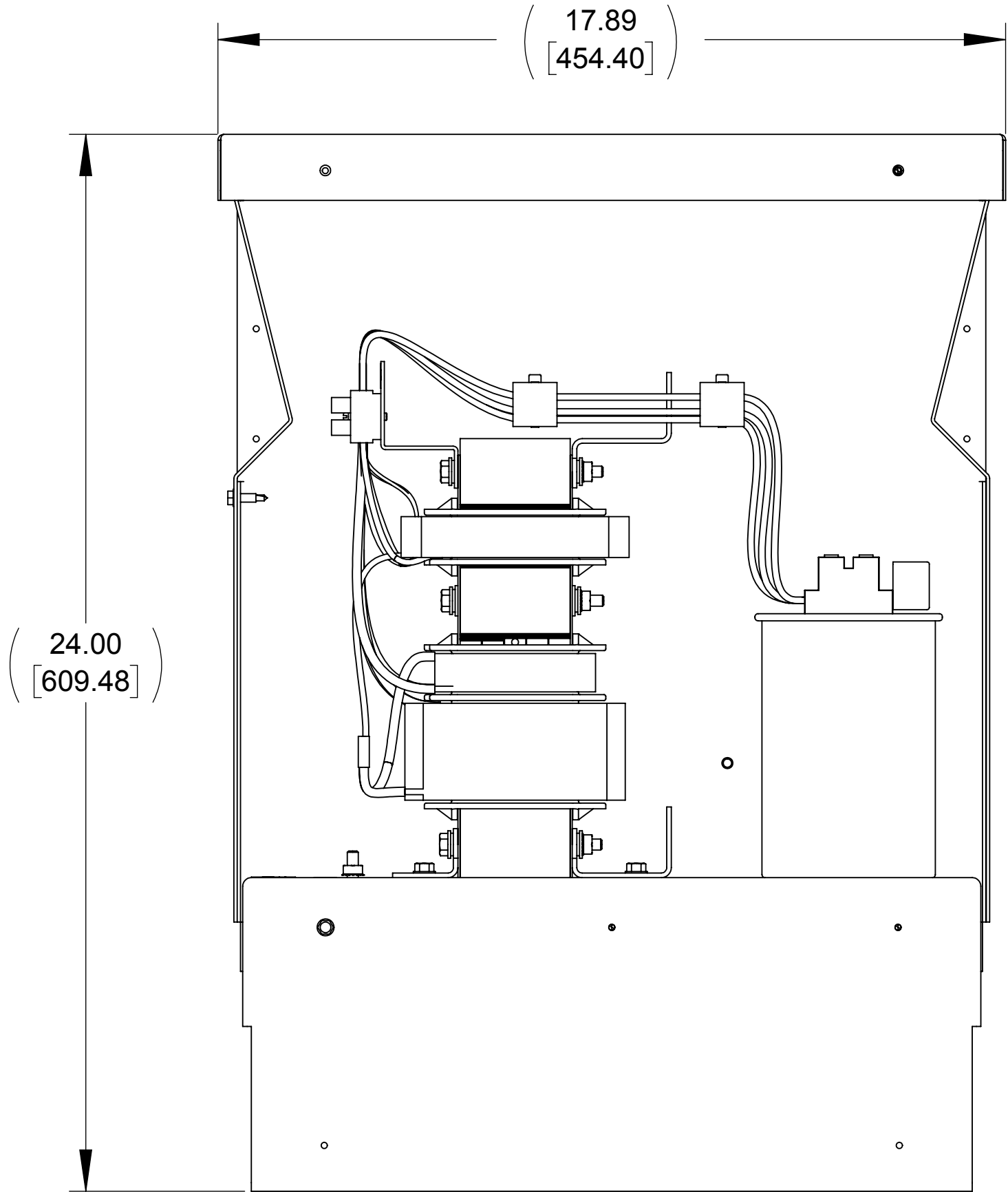

SIDE VIEW
(PANELS REMOVED)

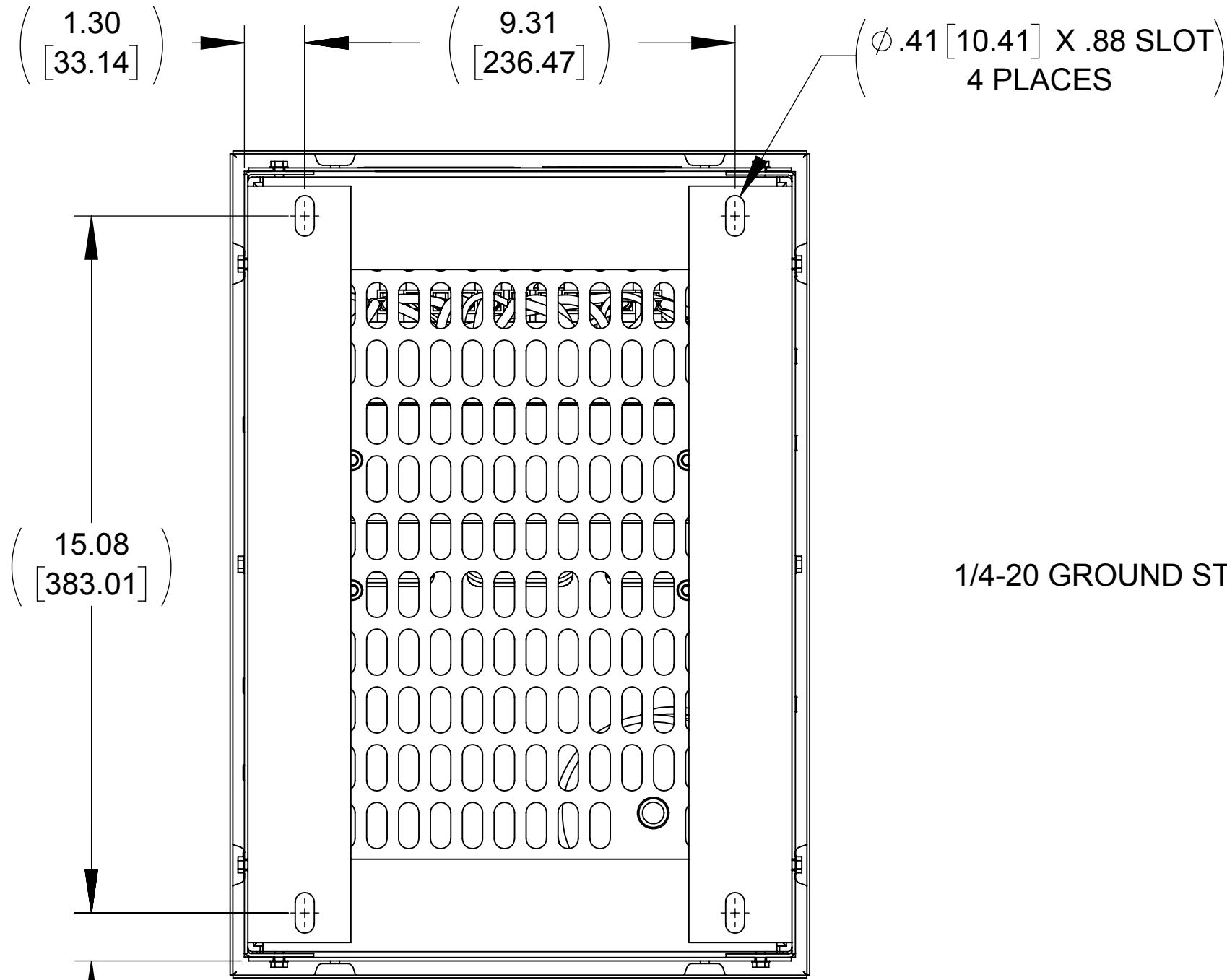

BOTTOM VIEW

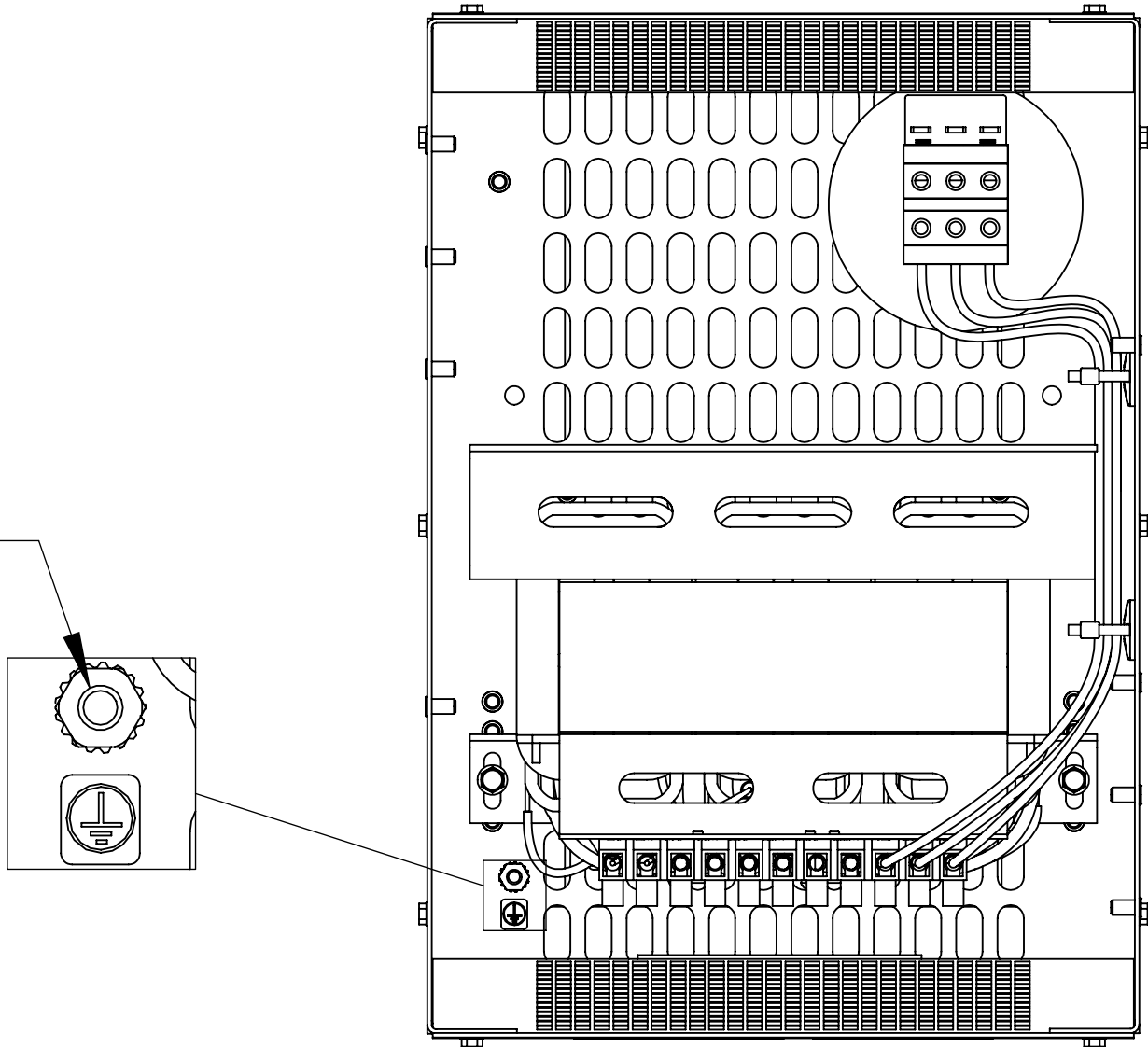
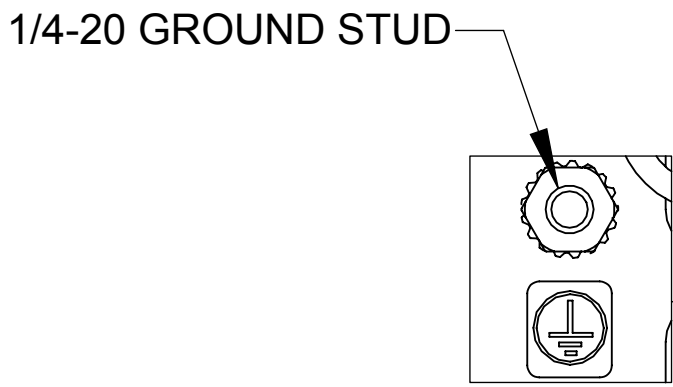

TOP VIEW
(PANEL REMOVED)

SEE NOTES 1, 2, & 3

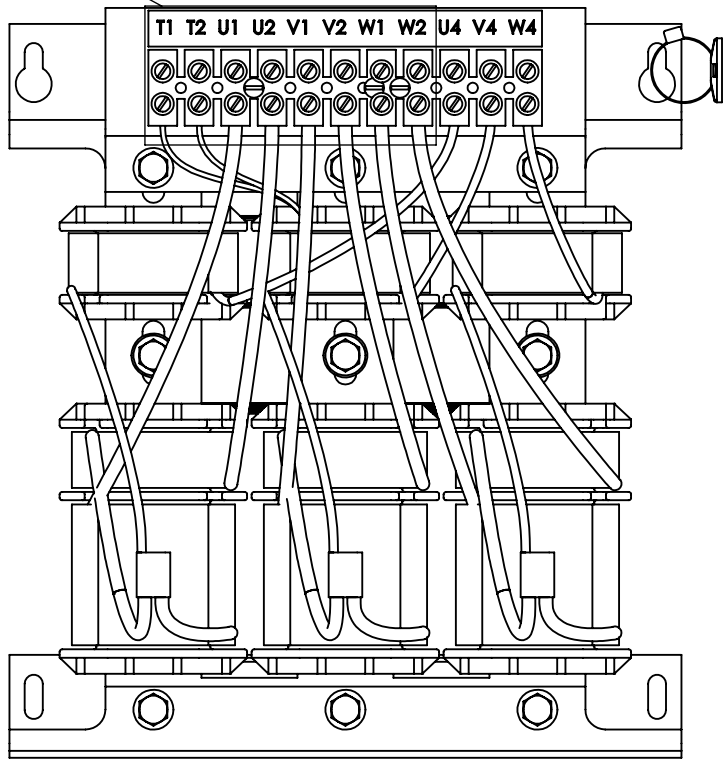
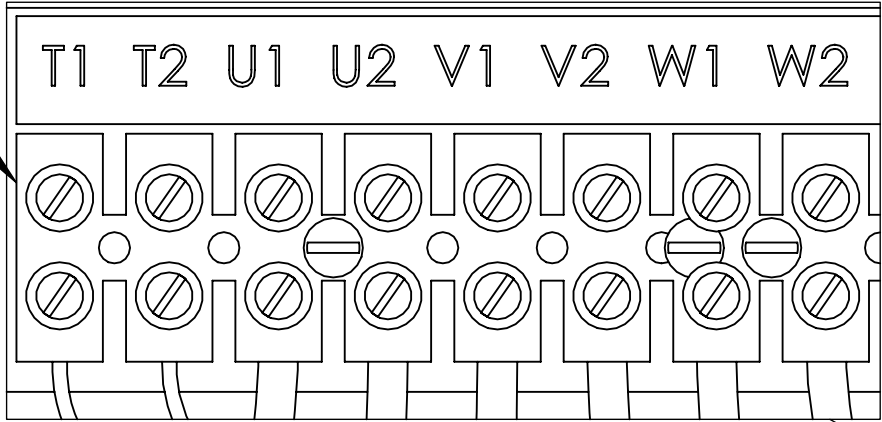

CUSTOMER CONNECTION
DETAIL VIEW AT REACTOR

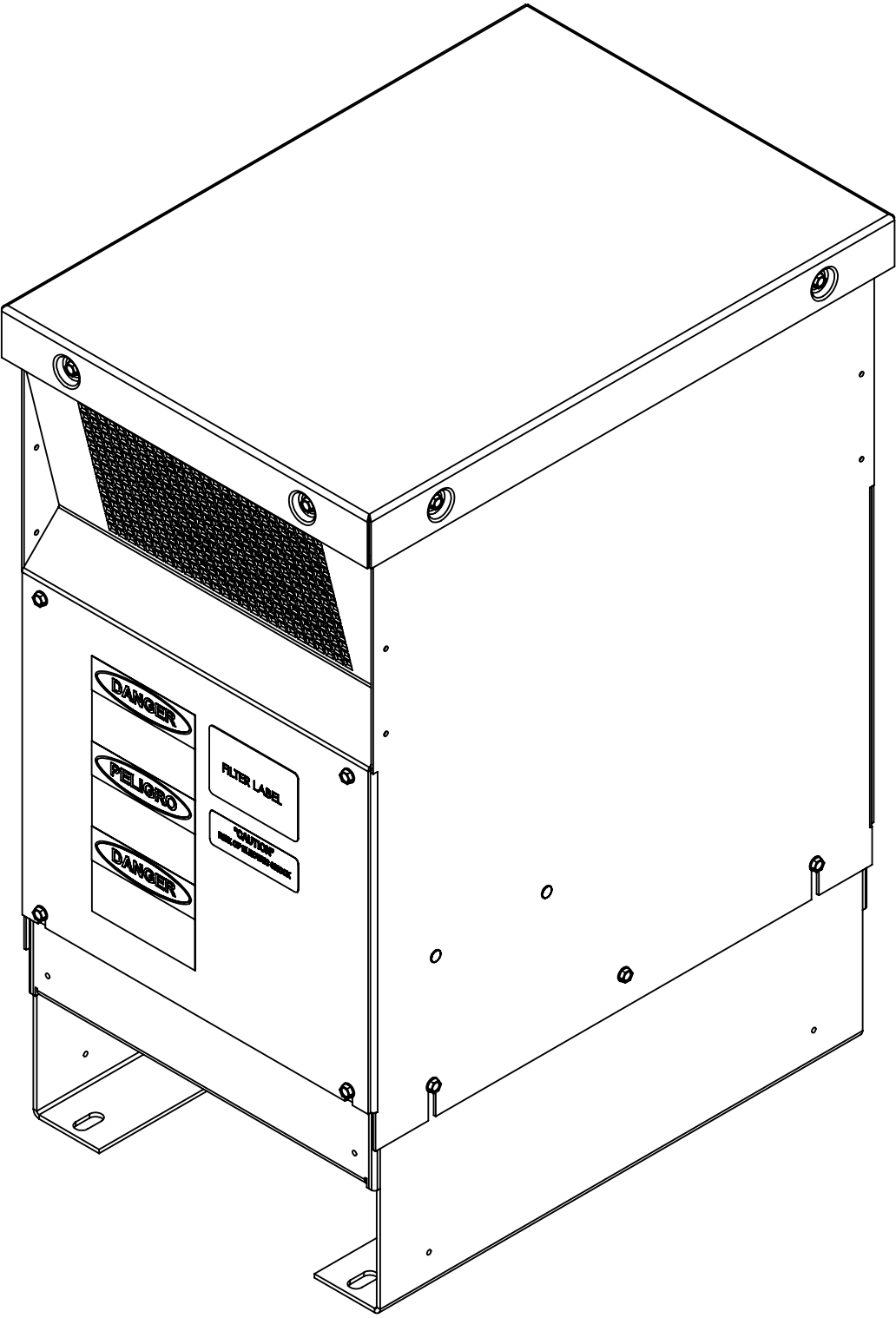

NOTES:

1. TERMINAL SCREW TIGHTENING TORQUE: 16 IN/LBS.
2. WIRE RANGE: 4-14 AWG.
3. CUSTOMER DOES NOT CONNECT TO U4, V4, & W4 LOCATED ON THE REACTOR TERMINAL BLOCK.

THE COMPONENT, PART OR ASSEMBLY DESCRIBED IN THIS DOCUMENT MUST COMPLY WITH THE EU(EUROPEAN UNION) DIRECTIVE RoHS2		MATERIAL		CONFIDENTIAL AND PROPRIETARY INFORMATION THIS DOCUMENT CONTAINS CONFIDENTIAL AND PROPRIETARY INFORMATION OF MTE CORPORATION AND MAY NOT BE USED, COPIED OR DISCLOSED TO OTHERS EXCEPT WITH THE AUTHORIZED WRITTEN PERMISSION OF MTE CORPORATION	
CONTAINS <0.1% OF ANY SVHC BY WEIGHT PER REACH REGULATION				DESCRIPTION	
UNLESS OTHERWISE SPECIFIED DIMENSIONS ARE IN INCHES [MM] TOLERANCES ARE: ANGLES: ± 1 ° 1 PLACE .X: ± .1 [2.5] 2 PLACE .XX: ± .03 [0.76] 3 PLACE .XXX: ± .010 [0.254]		MTE POWER QUALITY. SOLVED. N83 W13330 Leon Road Menomonee Falls, WI 53051 USA 800.455.4683 262.253.8200		MATRIX AP 34A 480V 60HZ FILTER, NEMA 1/2 ENCLOSURE	
		DRAWN JP	DATE 05/04/12	SIZE D	DWG No. CD MAPG0034D
		CHECKED SM	DATE 12/07/18	REV 02	
		APPROVED AK	DATE 12/10/18	SCALE 1:3	SHEET 1 OF 1