

WEIGHT (LBS)	INDUCTANCE	LOSS (WATTS)
4	0.53mH	38.3

ECO No	DESCRIPTION	REV BY	DATE
M8321	DIMENSION CHANGE	JP	12/14/12

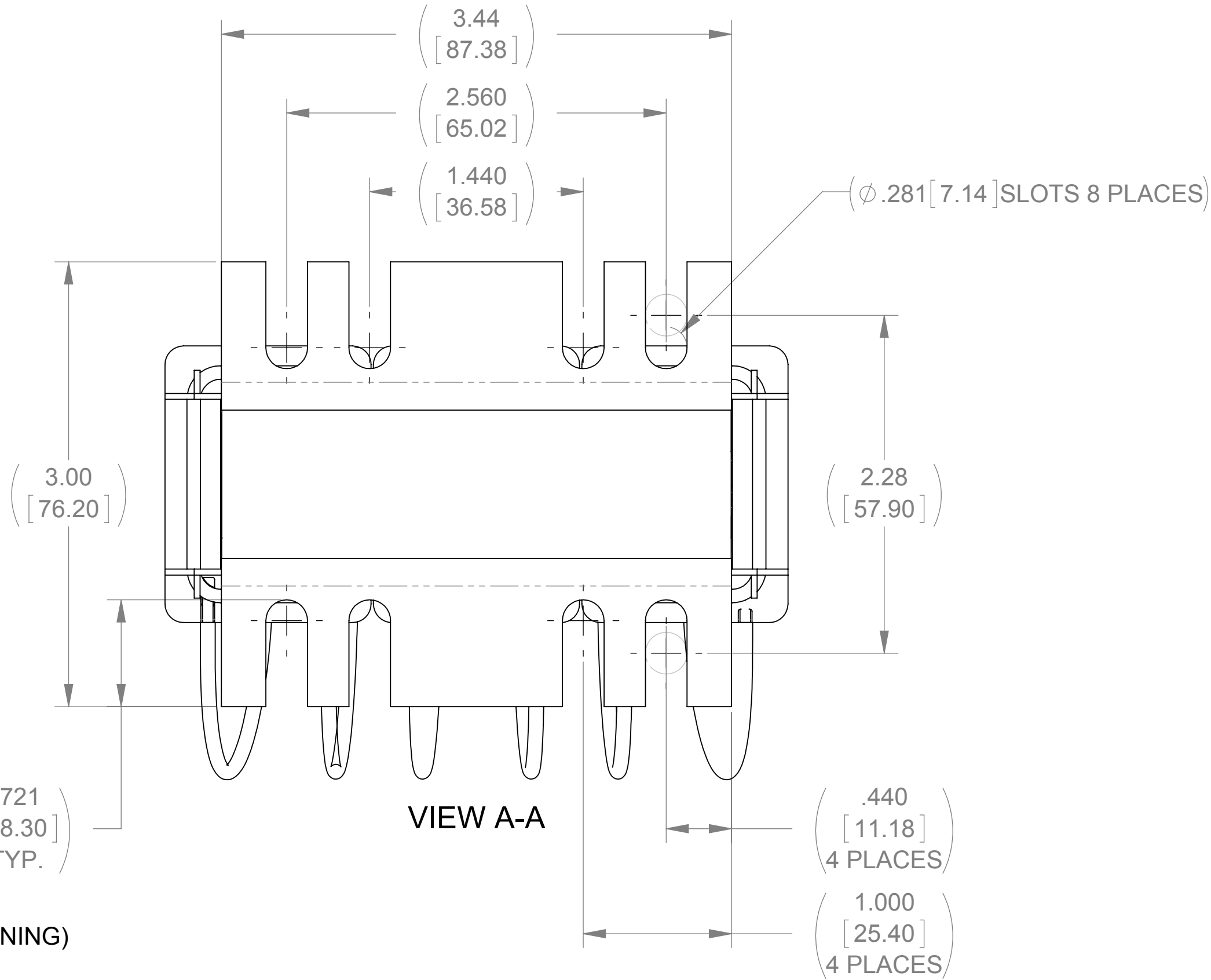

SEE NOTE (1)  
(TERMINAL SCREW TIGHTENING)

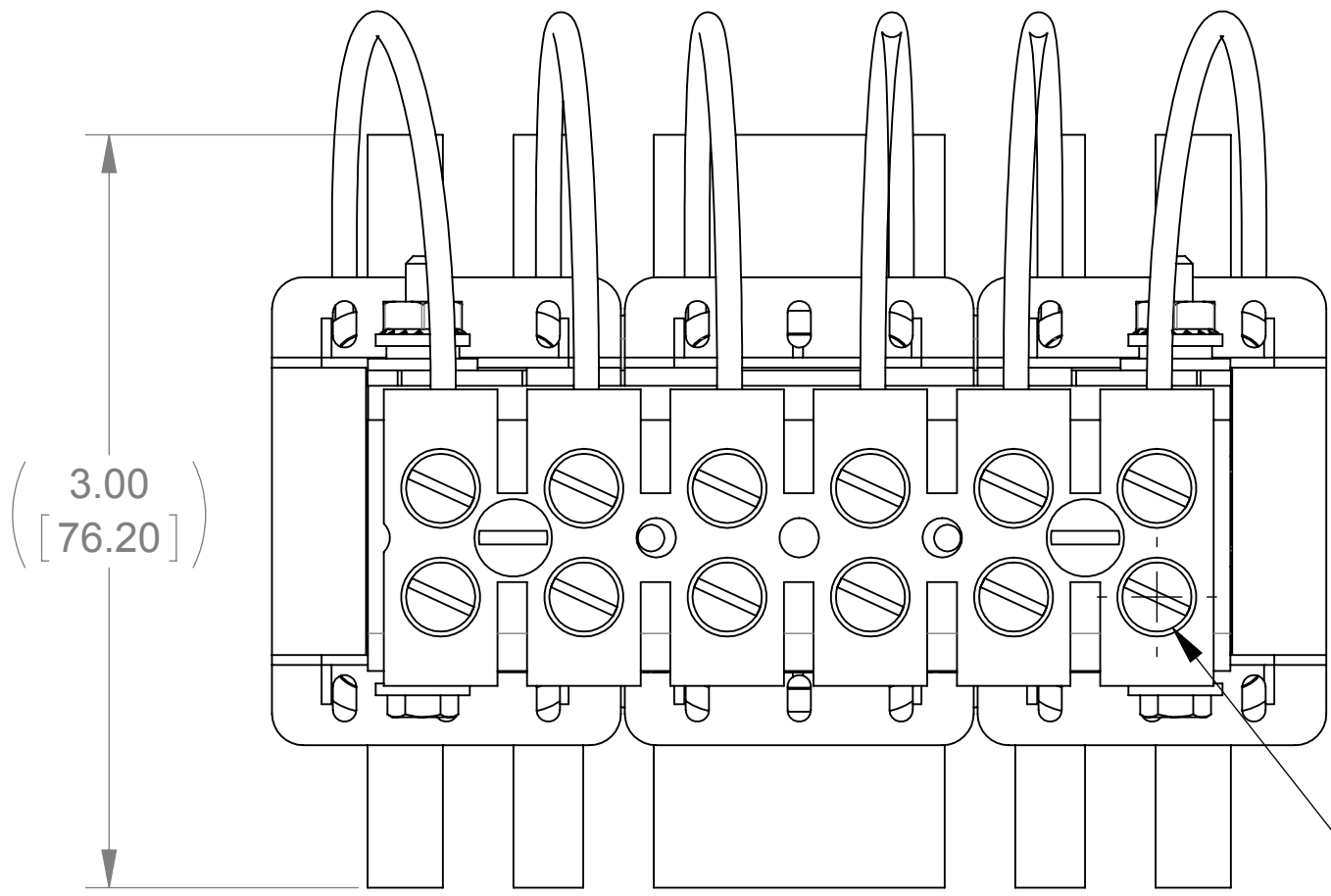
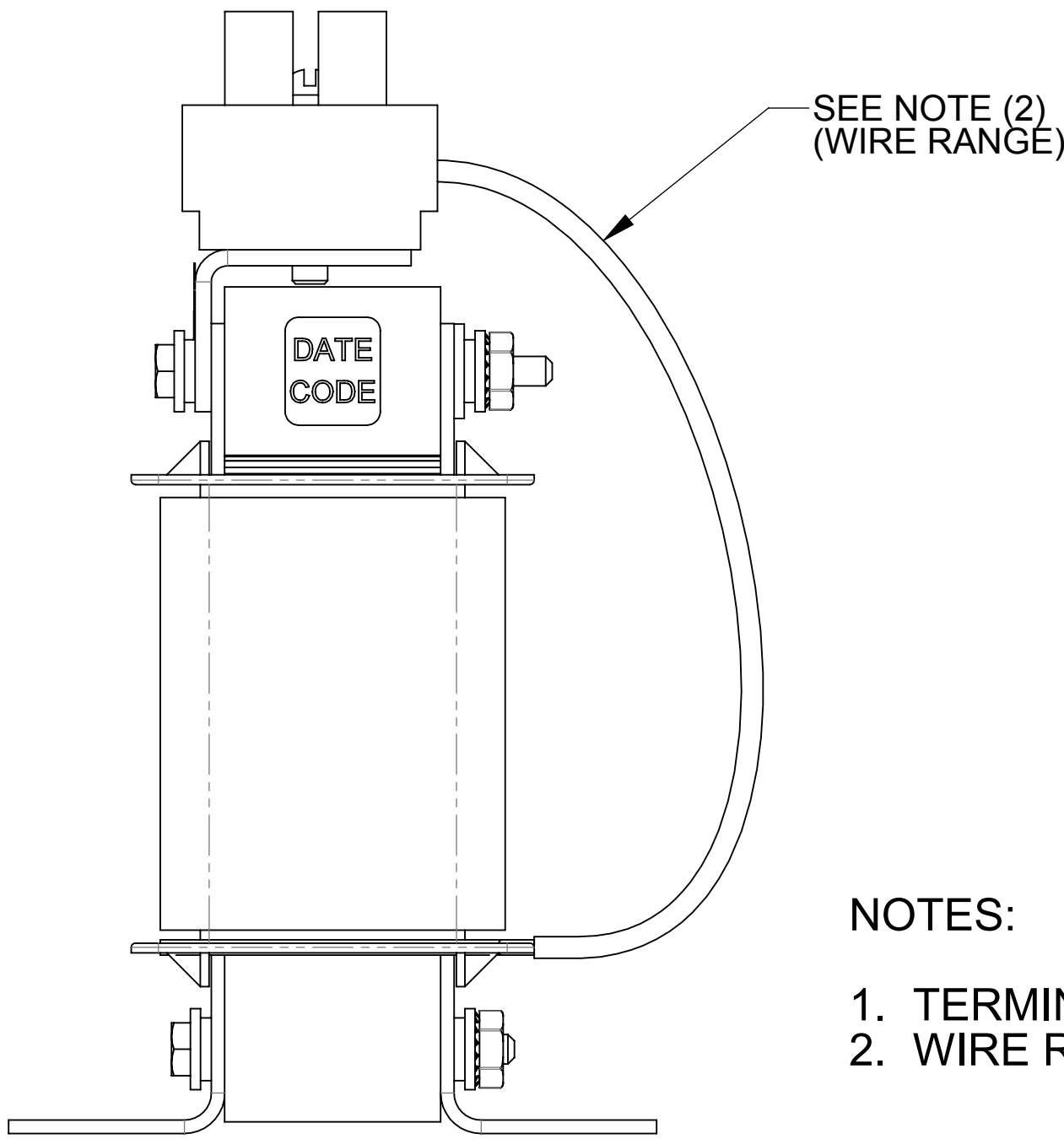
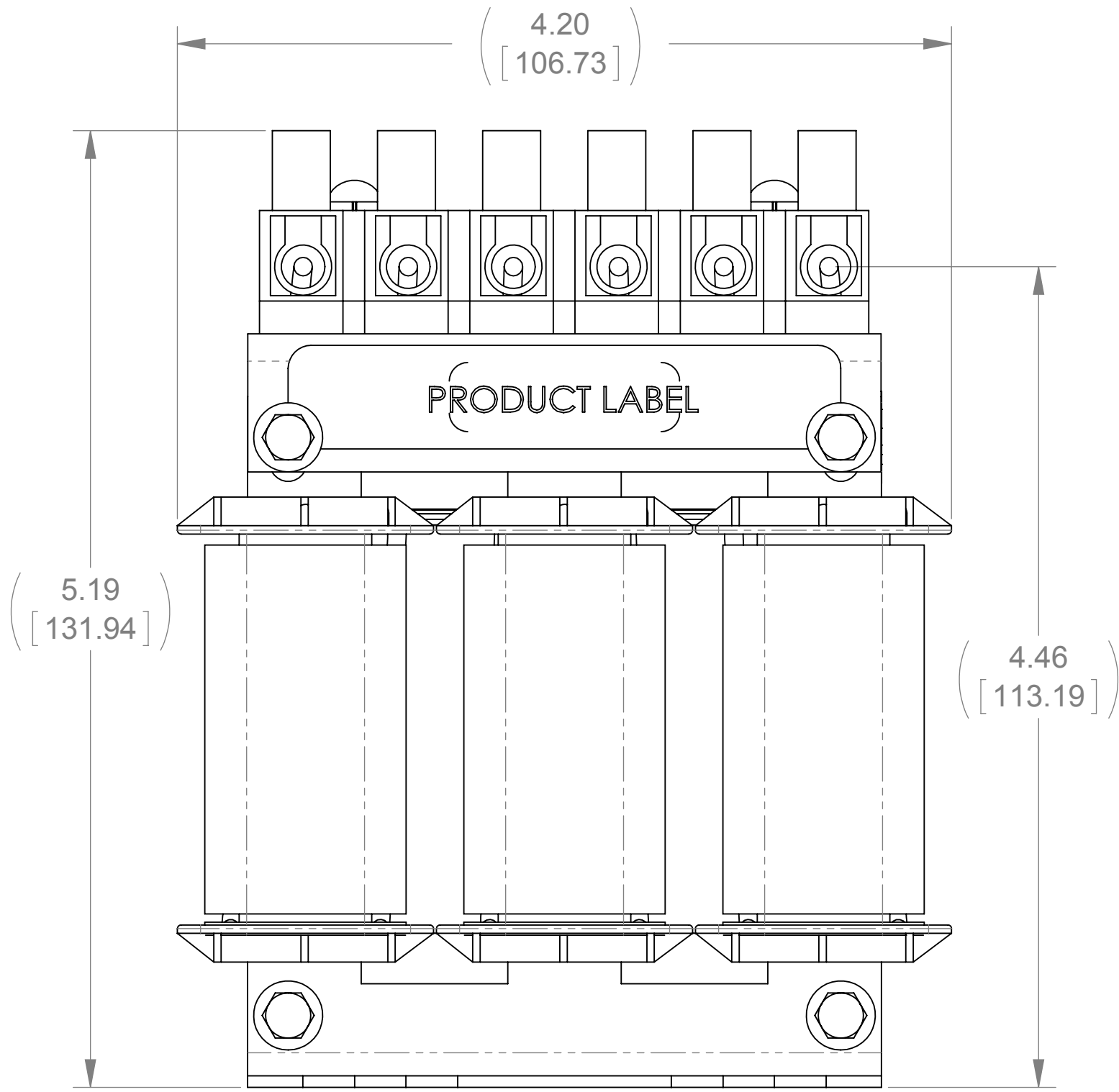

NOTES:

1. TERMINAL SCREW TIGHTENING TORQUE: 16 in-lbs MAX
2. WIRE RANGE: 14 - 6 AWG

THE COMPONENT, PART OR ASSEMBLY DESCRIBED IN THIS DOCUMENT MUST COMPLY WITH THE EU(EUROPEAN UNION) DIRECTIVE RoHS		MATERIAL		CONFIDENTIAL AND PROPRIETARY INFORMATION THIS DOCUMENT CONTAINS CONFIDENTIAL AND PROPRIETARY INFORMATION OF MTE CORPORATION AND MAY NOT BE USED, COPIED OR DISCLOSED TO OTHERS EXCEPT WITH THE AUTHORIZED WRITTEN PERMISSION OF MTE CORPORATION		
CONTAINS <0.1% OF ANY SVHC BY WEIGHT PER REACH REGULATION				DESCRIPTION		
UNLESS OTHERWISE SPECIFIED DIMENSIONS ARE IN INCHES [MM] TOLERANCES ARE: ANGLES: ± 1 ° 1 PLACE .X: ± .1 [2.5] 2 PLACE .XX: ± .03 [0.76] 3 PLACE .XXX: ± .010 [0.254]		<b>MTE</b> AN BL POWER ELECTRONICS COMPANY N83 W13330 Leon Road Menomonee Falls, WI 53051 USA 800.455.4683 262.253.8200		LINE REACTOR		
		DRAWN JP	DATE 08/31/12			
		CHECKED TM	DATE 12/21/12			
		APPROVED TM	DATE 12/21/12			
				SIZE D	DWG No. CD RLW-002101	REV 04
				SCALE 4:3	SHEET 1 OF 1	