

APPROX. WEIGHT (LBS)	INDUCTANCE	LOSS (WATTS)
2.43	12 mH	7.5

ECO No	DESCRIPTION	REV BY	DATE
M11732	UPDATE TO NEW TEMPLATE	MN	04/16/19

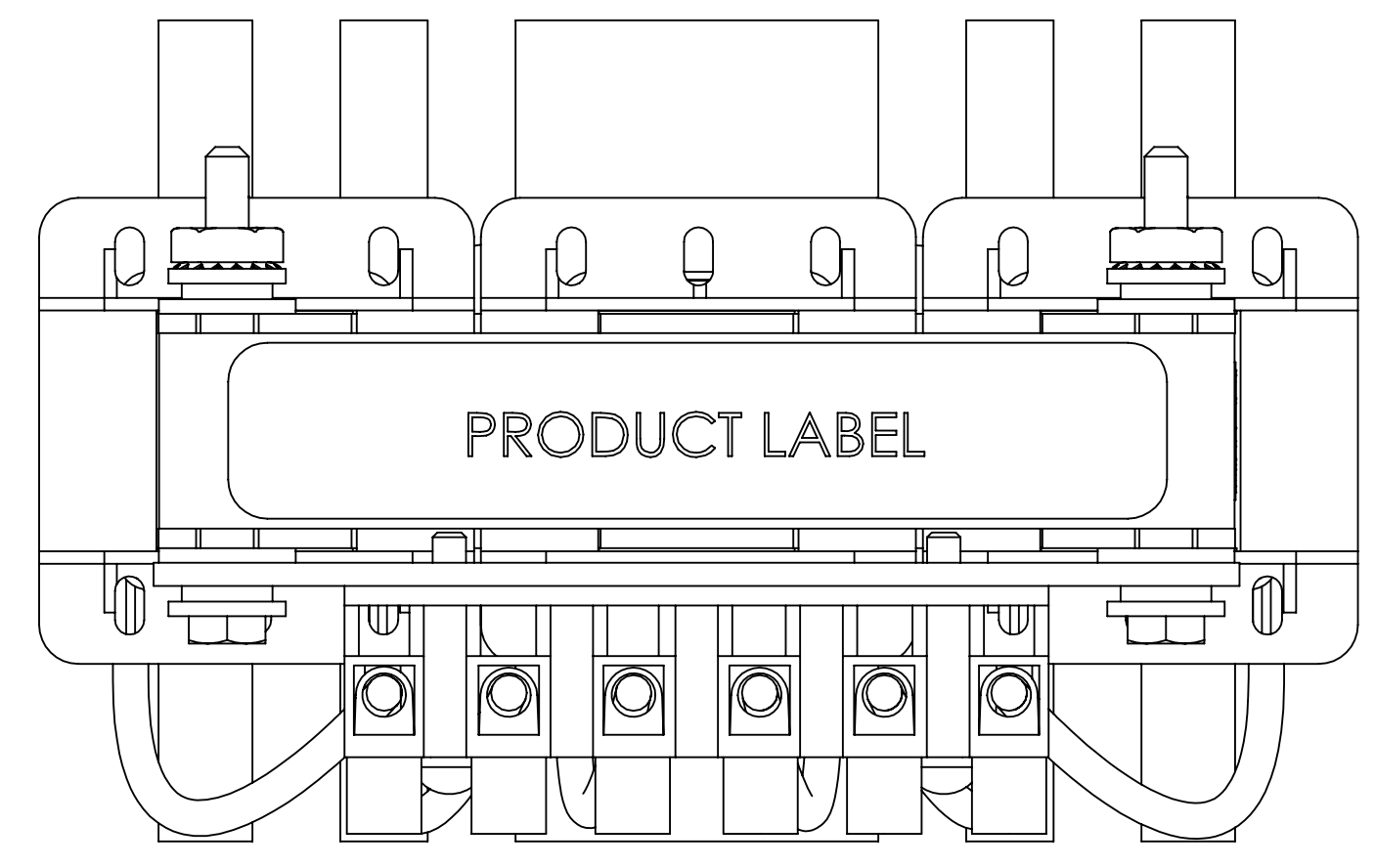

TOP VIEW

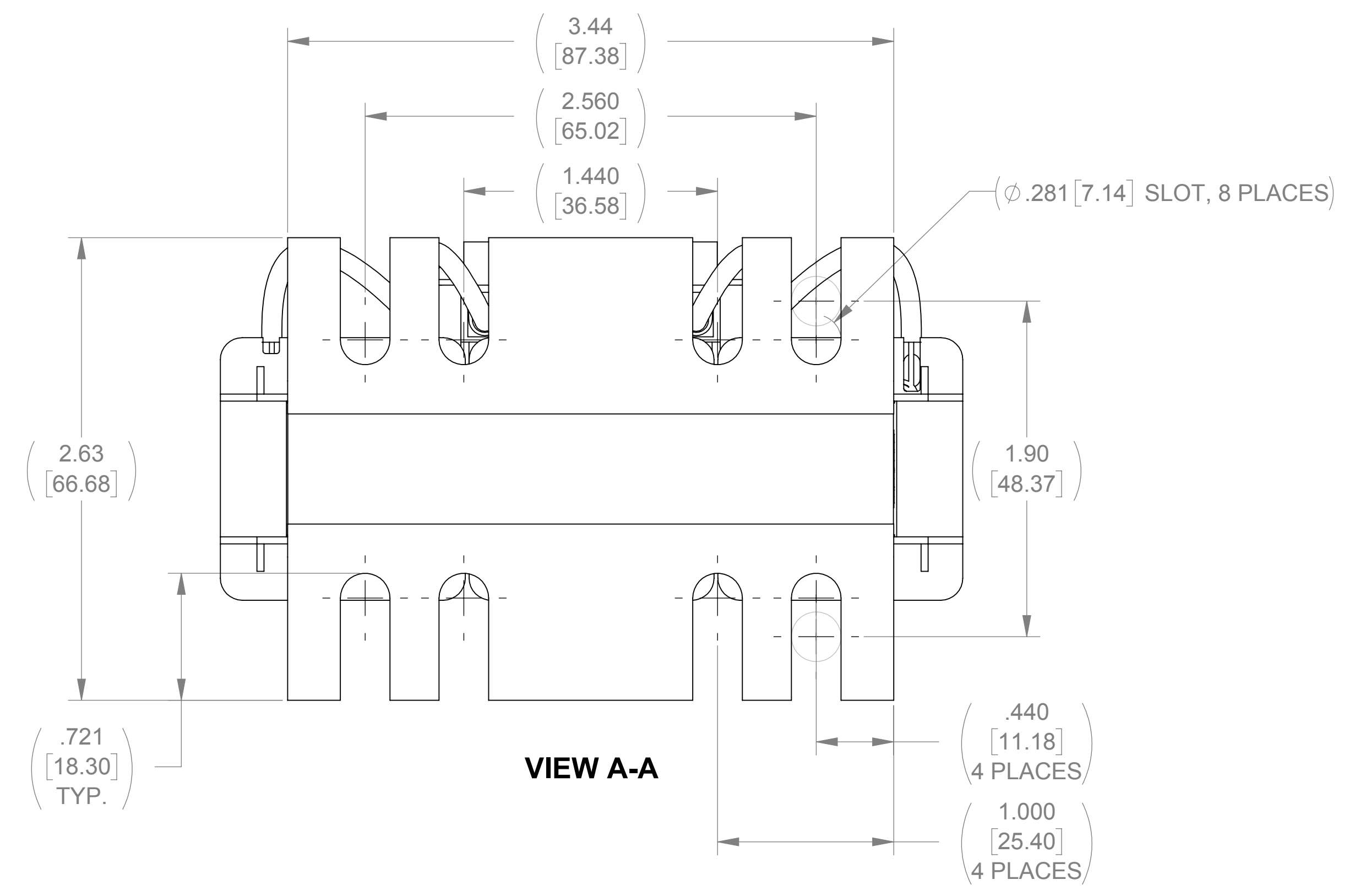

VIEW A-A

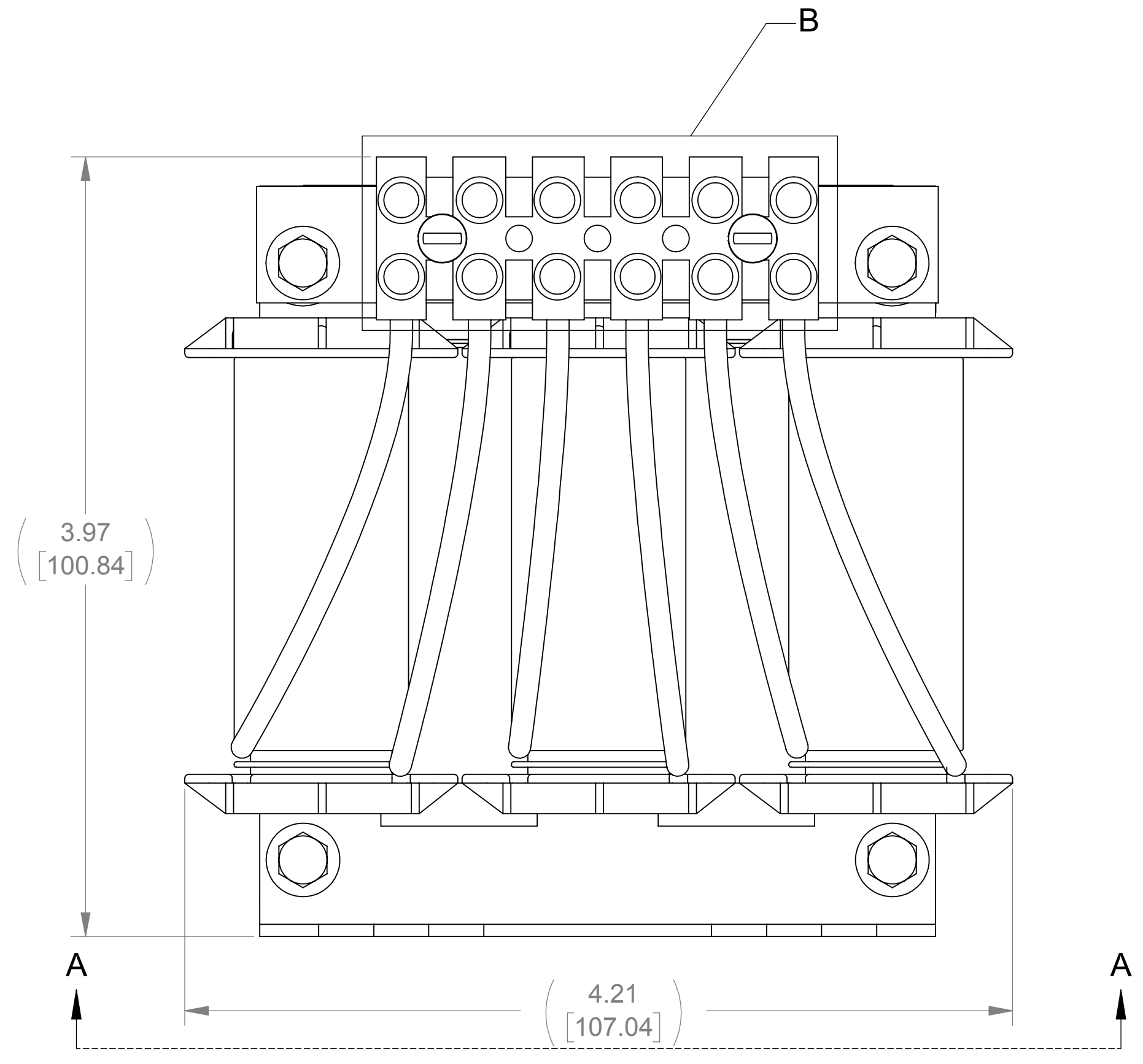
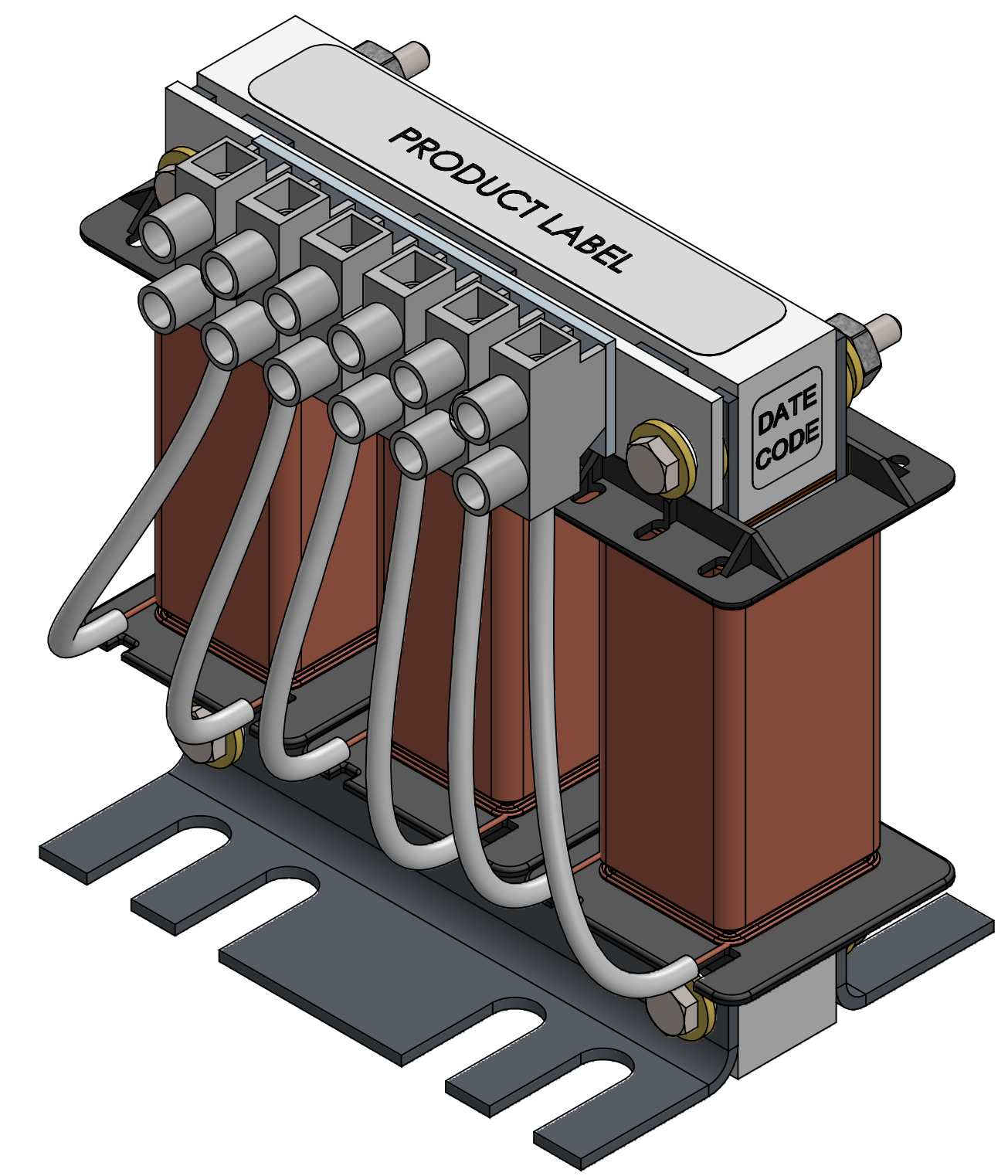

FRONT VIEW

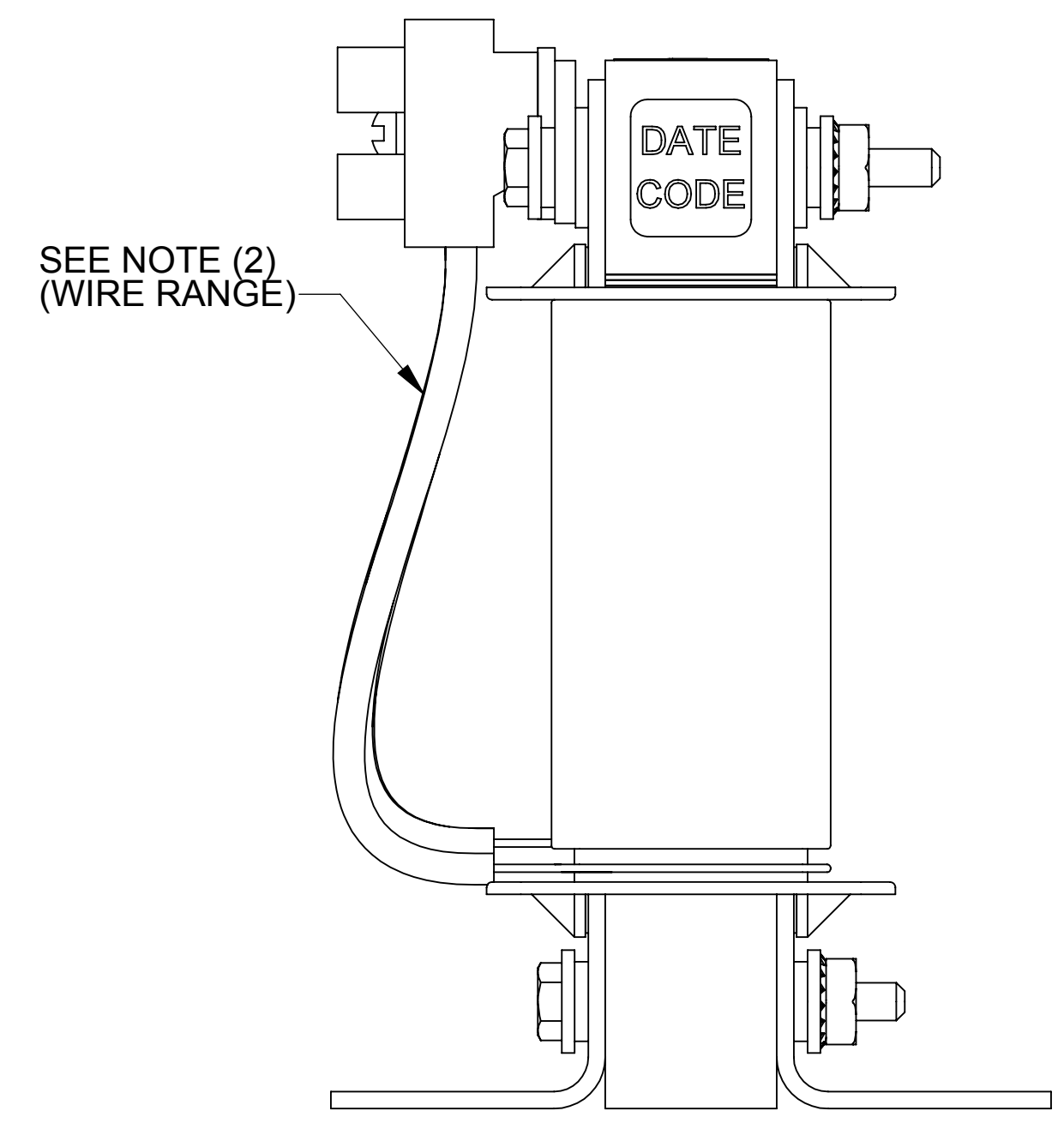

SIDE VIEW

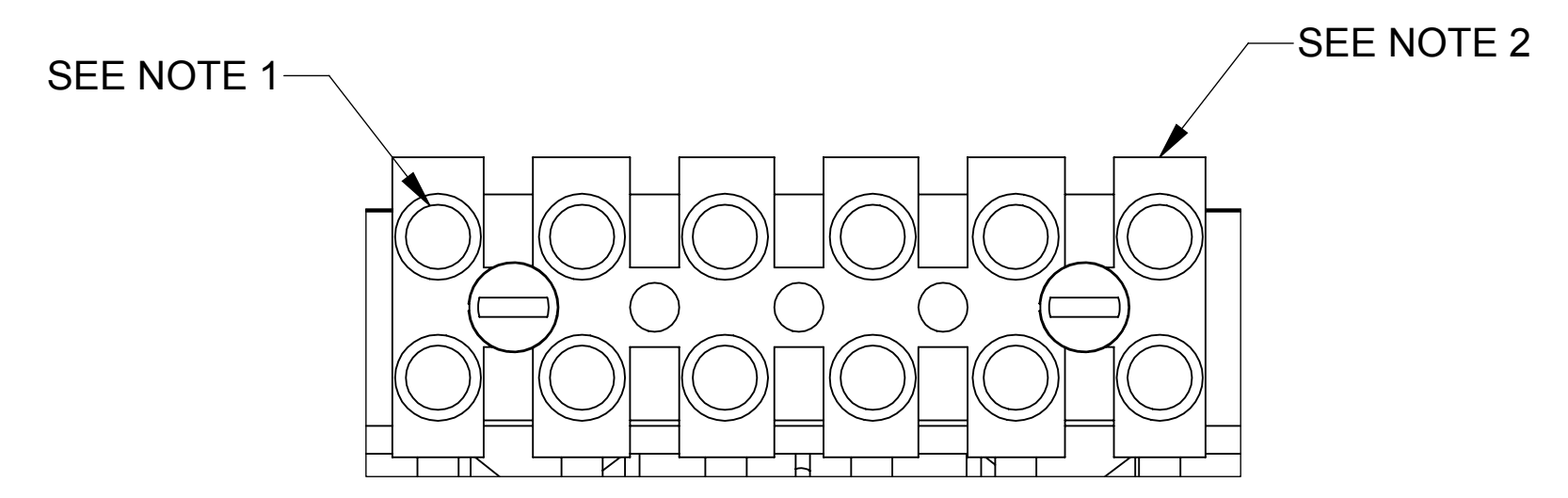

DETAIL B
CUSTOMER CONNECTION
DETAIL VIEW

NOTES:

1. TERMINAL SCREW TIGHTENING TORQUE: 4.5 IN/LBS.
2. WIRE RANGE: 22-10AWG.

THE COMPONENT, PART OR ASSEMBLY DESCRIBED IN THIS DOCUMENT MUST COMPLY WITH THE EU (EUROPEAN UNION) DIRECTIVE RoHS2		MATERIAL		CONFIDENTIAL AND PROPRIETARY INFORMATION THIS DOCUMENT CONTAINS CONFIDENTIAL AND PROPRIETARY INFORMATION OF MTE CORPORATION AND MAY NOT BE USED, COPIED OR DISCLOSED TO OTHERS EXCEPT WITH THE AUTHORIZED WRITTEN PERMISSION OF MTE CORPORATION				
CONTAINS <0.1% OF ANY SVHC BY WEIGHT PER REACH REGULATION				DESCRIPTION				
UNLESS OTHERWISE SPECIFIED DIMENSIONS ARE IN INCHES [MM] TOLERANCES ARE: ANGLES: ± 1° 1 PLACE .X: ± .1 [2.5] 2 PLACE .XX: ± .03 [0.76] 3 PLACE .XXX: ± .010 [0.254]		 N83 W13330 Leon Road Menomonee Falls, WI 53051 USA 800.455.4683 262.253.8200		LINE/LOAD REACTOR (2AMPS 12mH)				
				DRAWN	DATE	SIZE	DWG No.	REV
				SJW	03/06/90	D	CD RL-00201	14
		CHECKED	DATE	SCALE				
		MN	04/16/19	5:3				
		APPROVED	DATE	SHEET 1 OF 1				
		AK	04/16/19					